



Panacea® 6300 BARIATRIC BED

Content and Assembly Manual

Read this Content and Assembly Manual, along with your Owner's Manual, completely and carefully before proceeding with assembly procedures. Refer to your Owner's Manual for important definitions and symbols.

If you do not feel capable of performing this assembly, STOP – please contact Direct Supply® Equipment & Furnishings® or a capable service person to finish the assembly for you. Improper assembly will affect user safety and may void your warranty.

Package Contents

Panacea 6300 Package Contents:

- (1) main bed assembly
- (2) headboards and footboards
- (2) assist devices
- (1) wall guard
- (2) head and foot mattress rails
- (2) front mattress side guards
- (2) lower mattress side guards
- (1) handheld pendant
- (2) footboard mounts
- (2) headboard mounts with I.V. holder
- (2) head and foot mount rails with locking knobs
- (8) large hex head barrel shaft bolts
- (8) plastic headboard and footboard spacers
- (8) small hex button head bolts
- (4) locking head lag bolts with plastic hand knob

Required Tools for Assembly:

- Claw hammer or pry bar
- $\frac{3}{16}$ hex key wrench
- Utility knife/fresh blades
- Side-cutters
- Protective eyewear
- Protective gloves

⚠ NOTE: Unpack the bed in an area with sufficient room to work. Do not allow residents near the bed until it has been completely set up and the work area has been cleared of all debris.

⚠ WARNING: It is recommended that four people remove the bed from the pallet and safe lifting practices are used to avoid injury. **This bed weighs approximately 400 lbs.; please use caution and lift properly to prevent any strain or injury. Protective eyewear and gloves should be worn at all times during assembly.**

Prior to beginning assembly, inspect the bed for shipping damage. Also, verify the proper bed model and size was shipped. If you feel there was a mistake, or if the bed is damaged, DO NOT USE THE BED and immediately contact Direct Supply Equipment & Furnishings for further instruction.

Assembly

STEP 1. Uncrate the Bed

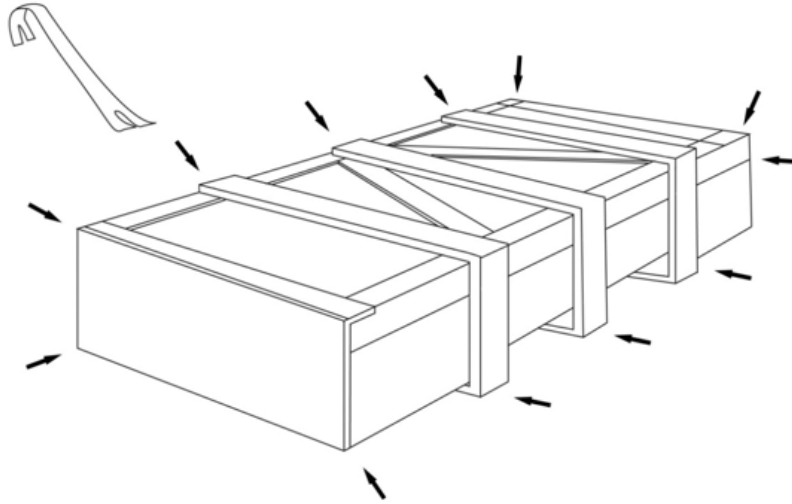

Cut black strapping around box and remove box enclosing bed frame. Using a claw hammer or a pry bar, carefully remove the wooden planks from the top and sides of the crate by prying against the existing boards. Use caution as to not pry against the cardboard and potentially damage your bed. Once the upper boards have been removed, proceed to remove the plywood guards on the front and back of the crate.

Discard all wood and nails in a safe and environmentally correct manner. These will no longer be used. Always verify all packaging materials have been safely removed prior to allowing residents back in the area.

Assembly *(cont.)*

STEP 2. Remove Cardboard Packaging

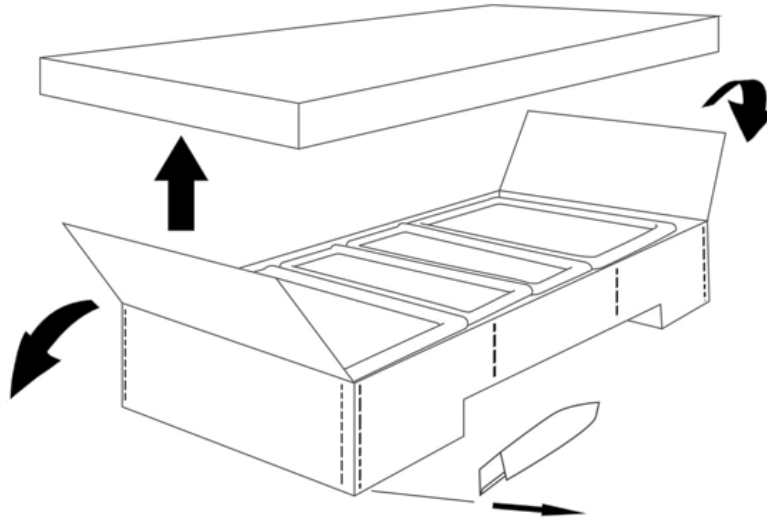

Using a utility knife with a fresh blade for safety, carefully cut along the sides of the box after removing the box lid and casting it aside. Remove any and all cardboard and foam packaging surrounding the bed. Any loose or wrapped parts sitting on top of the bed assembly should be cautiously unwrapped and set aside where they will not be damaged. Excess cardboard can be used as a mat to set parts on so they are not scratched during assembly.

Discard all unused cardboard in an environmentally safe manner.

STEP 3. Unwrapping Main Bed Assembly

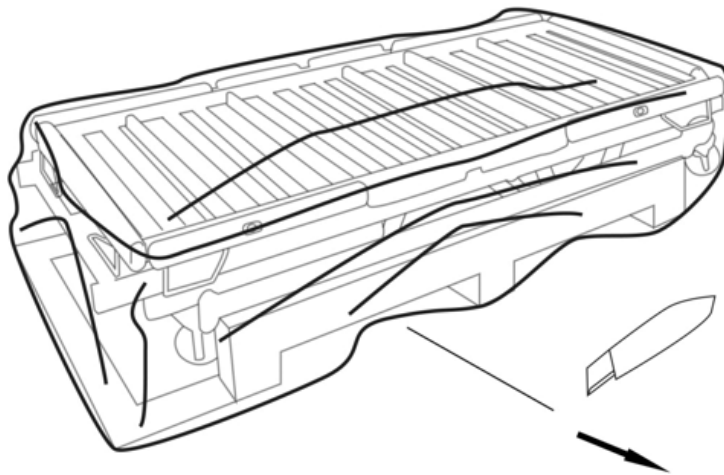

Using your utility knife with a fresh blade for safety, carefully remove all plastic packaging around the bed and wooden shipping frame. All Styrofoam and cardboard parts used during shipping should be discarded at this time. Cut and remove all plastic ties. Any loose or wrapped parts sitting on top of the bed assembly should be cautiously unwrapped and set aside where they will not be damaged. Excess cardboard can be used as a mat to set parts on so they are not scratched during assembly.

Discard all plastic and shipping material in an environmentally safe manner.

Assembly *(cont.)*

STEP 4. Removing Wall Guard

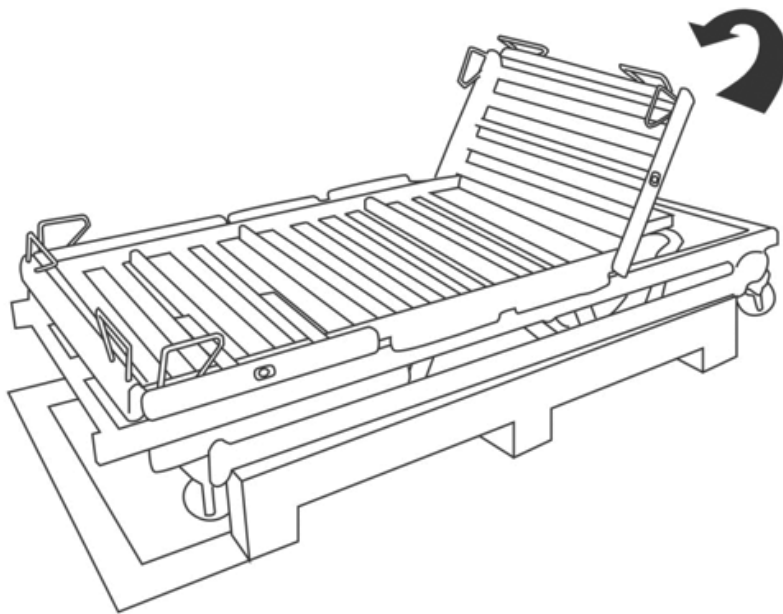

Using care, manually raise the headboard section of the bed to an upright fixed position.

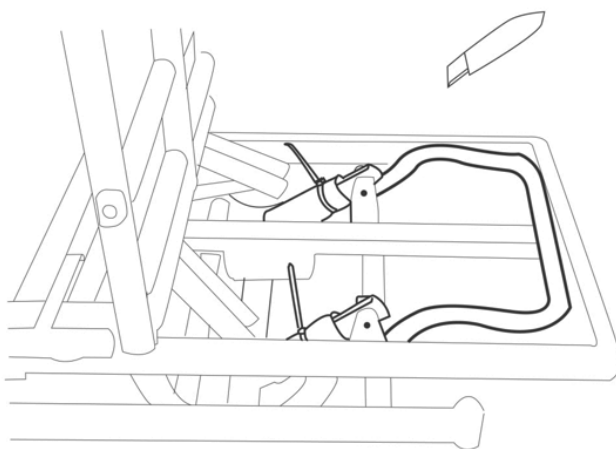

Cut nylon ties along the lift rails and free the wall guard. Remove all packaging and set wall guard aside.

Discard any shipping material in an environmentally safe manner.

STEP 5. Handrail Removal

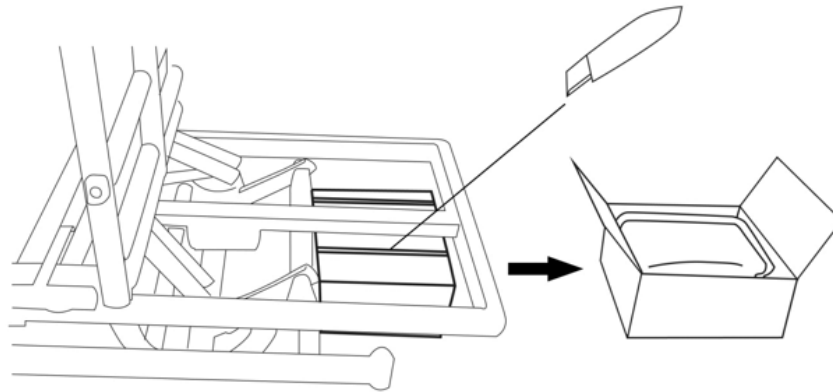

Once the wall guard has been removed, you will see a separate cardboard container underneath the main bed frame's headboard section. This box contains the handrails and is bound securely to the wooden sub frame via thick nylon ties. Although a utility knife can be used to cut these ties, it is easier and safer to use a pair of side-cutters to remove the straps. **Please use great caution when removing these using a utility knife. Remember to always use a clean, sharp blade to ensure safety.**

Once free, slide the box out from under the bed frame. Open the box using your knife carefully as to not damage the handrails inside. Remove and unwrap handrails and set aside where they will not be damaged.

Lower the headboard section back down to its flat lying position.

Discard any shipping material in an environmentally safe manner.

Assembly *(cont.)*

STEP 6. Test Bed Functions

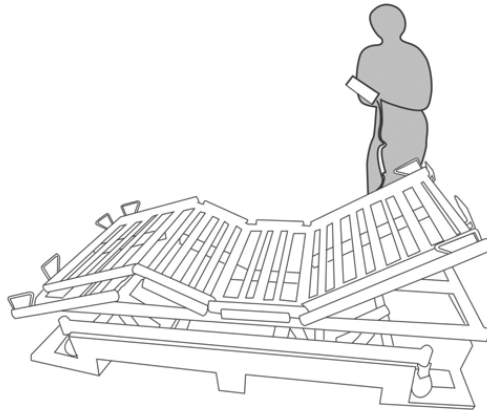

Once the bed is free from all packaging constraints, unwrap and unravel the electrical cord attached to the bottom of the electric motor assembly found underneath the bed. Plug bed into a standard 3-prong 110V wall outlet.

Using the hand pendant controller, put the bed through all of its proper function cycles of raised and lowered heights and contour functions.

Please STOP further assembly and notify Direct Supply® Equipment & Furnishings® immediately if there is a problem with the functional abilities of the bed.

Once satisfied with the bed function, please lower the bed back down to the low-lying, flat position. Unplug bed from wall and gather cord.

STEP 7. Handrail Placement

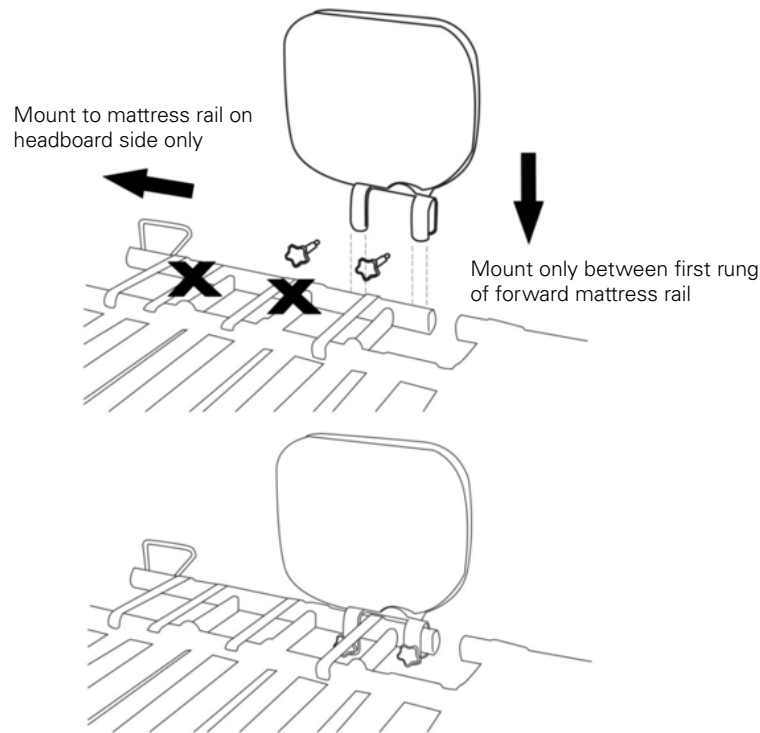

⚠ WARNING: Please take careful note to ensure the correct placement of the handrail.
If the rail is placed incorrectly, it may pose an entrapment risk to your resident.

Resident entrapment with rails may cause injury or death. To help prevent entrapment, you should follow the FDA's Entrapment Guidance and your healthcare provider's recommendations to choosing a bed, mattress and accessories that are appropriate for the specific resident. In addition, some states may prohibit rails or consider rails to be resident restraints. Always assess whether restraints are needed on a case-by-case basis and document the need for any resident restraint. Contact your state surveyor for further guidance regarding rails and restraints. Using the corresponding left and right side handrails, place each handrail on the mattress guard rail on the headboard section of the bed. The padded side should be facing the resident. The "short end" of the handrail should face the footboard. Take care to place the rail on the **FAR END ONLY** with only the first adjustment rail and ruled mattress guide falling between the lower rungs of the handrail. Please note pictures for correct placement. Note the handrail should not block any buttons or functions when placed correctly on the proper side of the bed.

Slide out mattress rail and use the (4) locking lag bolts and knobs to fasten the handrails. The lag bolts should slide through the rail with the notched section of the bolt fitting inside the handrail. Knobs are to be installed on the inside of the mattress rail as shown.

⚠ WARNING: Ensure siderails are aligned with arrow stickers on bed frame.

Assembly *(cont.)*

Step 8. Footboard Assembly

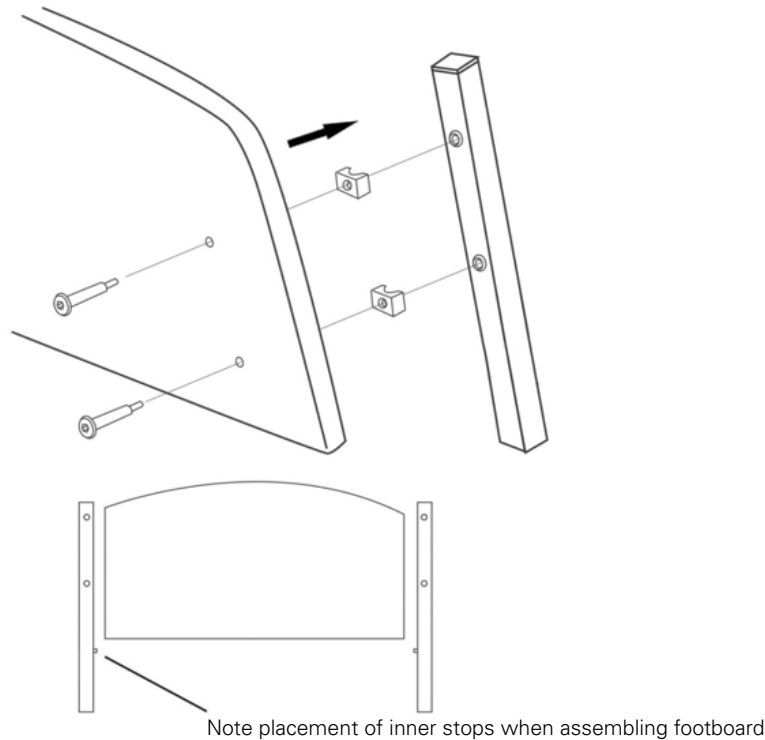

Locate a headboard/footboard, (4) large hex head barrel shaft bolts, (4) plastic headboard/footboard spacers and your (2) footboard mounts. Please note the correct location of the stopper on inside of the footboard mounts. These are to face the inside of the footboard. This step is best performed by laying the footboard on a table or using the bed frame top as a table.

Holding the footboard mount with the eyelets facing upward, place the plastic spacers over the top of the exposed holes. The hub-centric design should prevent the spacer from sliding off of the mount. Position the mount underneath the footboard so the holes line up evenly. Note the stopper faces the inside of the mount. Take one of the large hex bolts and insert it through the hole of the footboard. Carefully align the bolt through the plastic spacer and into the footboard mount. Tighten gently at first as to not cross thread the bolt. Use your 3/16 wrench to snug the bolt. Repeat on both holes on both sides of the board. Once all bolts are inside the mounts, fully tighten each bolt against the footboard.

For Beds Equipped with Staff Control:

- Insert the footboard into the mounting bracket with the staff control panel buttons facing away from the bed.
- Locate the end of the extension cable located near the foot end of the bed.
- Connect the end of the staff control cable to the end of the extension cable. If there is an o-ring on the end of the staff control cable, remove this prior to making the connection.
- Close the locking hood over the end of the staff control cable.

STEP 9. Headboard Assembly

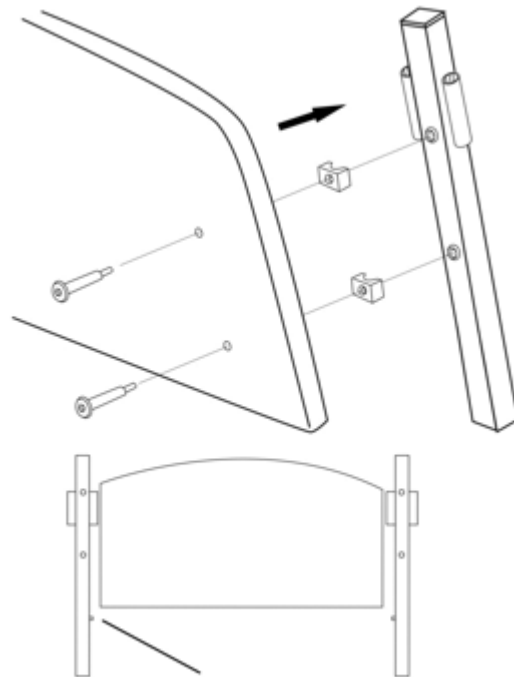

Note placement of inner stops when assembling footboard

Locate a headboard/footboard, (4) large hex head barrel shaft bolts, (4) plastic headboard/footboard spacers and your (2) headboard mounts. Please note correct location of the stopper on the inside of the headboard mounts. These are to face the inside of the headboard. This step is best performed laying the headboard on a table or using the bed frame top as a working surface.

Holding the headboard mount with the eyelets facing upward, place the plastic spacers over the top of the exposed holes. The hub-centric design should prevent the spacer from sliding off of the mount. Position the mount underneath the headboard so the holes line up evenly. Note the stopper faces the inside of the mount. Take one of the large hex bolts and insert it through the hole of the headboard. Carefully align the bolt through the plastic spacer and into the headboard mount. Tighten gently at first as to not cross thread the bolt. Use your 3/16 wrench to snug the bolt. Repeat on both holes on both sides of the board. Once all bolts are inside the mounts, fully tighten each bolt against the headboard.

Assembly *(cont.)*

STEP 10. Headboard and Footboard Placement

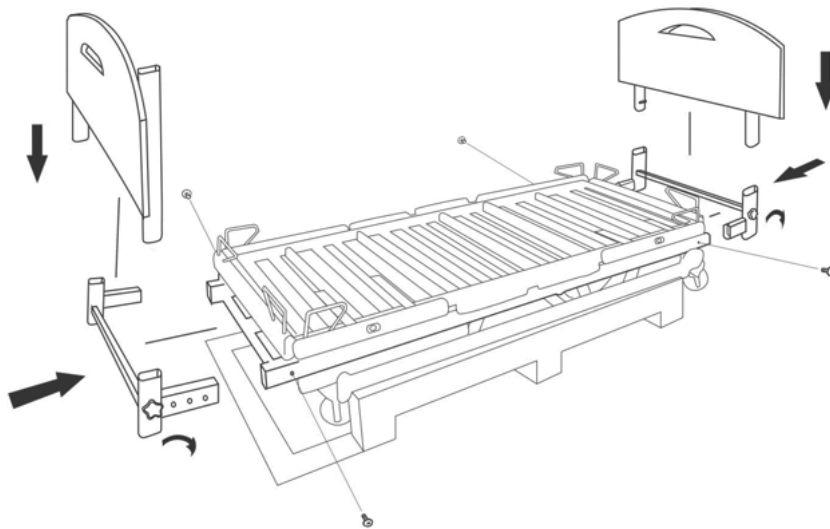

Locate the two head and foot mount rails with locking knobs. Slide each rail into the end of the frame with the mount receptacle facing upward. Adjust proper desired length and fasten to frame using (4) small button head hex bolts.

Once the mount rails are secure, lower both the footboard and headboard into the receptacles. Note the facing position of the boards, ensuring both face toward the foot end of the bed. Adjust each to desired height and lock into place using the knobs found on the outside of the mount rails.

STEP 11. Completed Bed Removal from Wooden Sub Frame

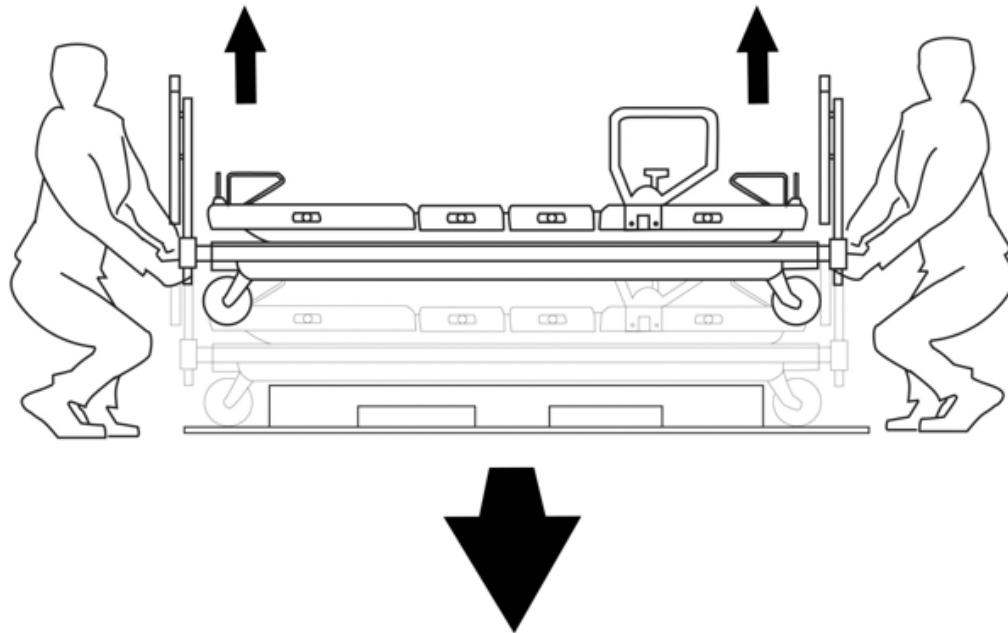

This step requires four able individuals to remove the assembled bed from the wooden sub frame. Each individual will be required to lift 100 lbs. off of the frame and walk it aside. Although the bed does not need to be lifted more than a few inches to clear the wood frame, this task can be strenuous for a smaller individual or someone with known back issues.

Please be sure to employ proper lifting techniques of keeping the back straight and lifting using the legs.

** Headboards and footboards can be removed for this step, along with mattress rails, to reduce weight, if needed.*

Once the bed is on the ground resting on its casters, lock each caster into place to prevent the bed from rolling.

Assembly *(cont.)*

STEP 12. Wall Guard Placement

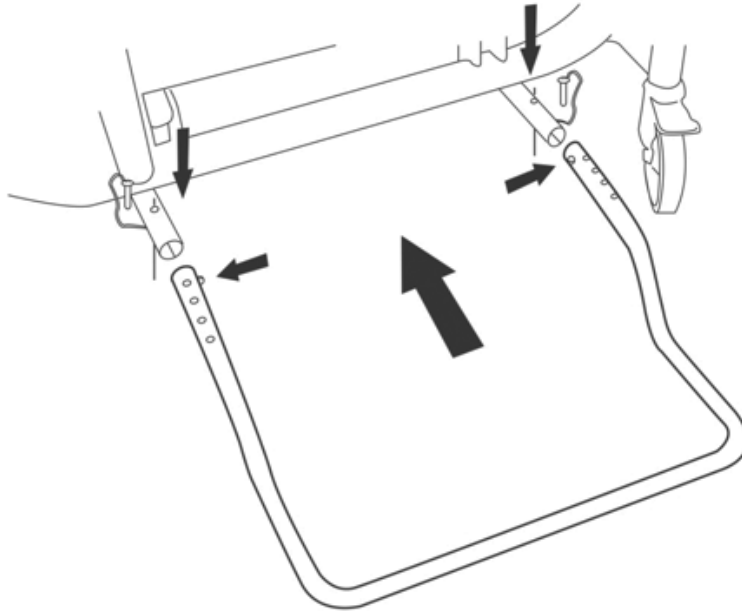

Locate the wall guard removed earlier from underneath the bed. The wall guard should be inserted into the round, drilled receptacles found under the headboard section of the bed. The guard features sprung ball socket locks along the inner rails. They will need to be depressed as you clear each hole in the receptacle. Guard should be adjusted to proper length determined by how far the bed should sit away from the wall. Guard is designed to rest against the wall's floor molding.

Note hole clearance for ball, as these can be tight fitting from powder coating. Some effort may be required to start the locks through.

Once the guard has been correctly positioned in the bed; use the locking safety pins to finally secure the wall guard to the frame. These may also require effort if there is any bind on the wall guard. You can use the blunt end of the claw hammer to gently tap these into place, if needed.

**YOU HAVE NOW COMPLETED THE ASSEMBLY OF YOUR
PANACEA® 6300 BARIATRIC BED.**

Be sure to double-check all bolts and part placements on the bed. Also, be sure to remove all packaging materials from the area before allowing residents into the area. Place the bed against the wall and supply electricity.

**READ THE ENTIRE OWNER'S MANUAL PRIOR TO USE, AND REFER TO THE OWNER'S
MANUAL FOR LIMITED WARRANTY INFORMATION.**



DirectSupply.com

Aptura / Equipment & Furnishings / Capital Projects / DSSI / TELS

Panacea® products are available to purchase exclusively through Direct Supply® Equipment & Furnishings™, a division of Direct Supply®, Inc. Distributed by Direct Supply Manufacturing, Inc. 6699 N Industrial Road, Milwaukee WI 53223.

© 2011-2015 Direct Supply Manufacturing, Inc. All Rights Reserved. Direct Supply®, Panacea®, and all associated logos are the registered trademarks of Direct Supply Inc., used under license.