



Direct Supply® Direct Choice™ IV Poles

Product Warranty

We warrant to you, the original purchaser, that your Direct Choice IV Poles will be free from defects in material and workmanship for a period of two years from the date they were shipped to you, given normal use and proper care. We will not be responsible for any product failure due to abuse, misuse, modification, improper use or any use which exceeds the published capacity of the Product. In the event of a warranty claim, we will repair, replace or adjust, at our option, the affected Direct Choice IV Pole. In certain cases, we may provide you repair or adjustment instructions and/or replacement parts, and ask you to perform a repair or adjustment or replace a defective part. This warranty is exclusive and in lieu of all other warranties, whether written, oral, expressed, implied or statutory. No expressed or implied warranty of merchantability or fitness for a particular purpose applies.

Product/Part	Warranty Period & Coverage (Parts)	Anticipated Usable Product Life
IV Poles	2 years	2 years

Anticipated Usable Product Life is based on normal use with proper maintenance, cleaning, and storage. You should still inspect, monitor, and care for the product as described in this guide, as the product may need to be replaced sooner than expected in particular situations.

DIRECT SUPPLY® MANUFACTURING™, INC. MAKES NO IMPLIED WARRANTIES OF MERCHANTABILITY OR FITNESS FOR A PARTICULAR PURPOSE; THESE AND ALL OTHER IMPLIED WARRANTIES ARE SPECIFICALLY DISCLAIMED. TO THE FULLEST EXTENT ALLOWED BY LAW, DIRECT SUPPLY MANUFACTURING INC. WILL NOT BE LIABLE FOR ANY INCIDENTAL, SPECIAL, CONSEQUENTIAL OR PUNITIVE DAMAGES, OR LOST PROFITS THAT MAY RESULT FROM THE DEVICE OR YOUR USE OF OR INABILITY TO USE THE DEVICE EVEN IF ADVISED OF THE POSSIBILITY OF SUCH DAMAGES. OUR TOTAL LIABILITY TO YOU, IF ANY, IS LIMITED TO THE PRICE OF THE DEVICE OR SERVICE GIVING RISE TO YOUR CLAIM. Some states do not allow an exclusion or limitation of incidental or consequential damages or how long an implied warranty lasts, so the above limitations or exclusions may not apply to you. If implied warranties are not excluded, and to the extent allowed by law, we limit any and all implied warranties to the applicable warranty period identified above. Except for rights under any applicable state law, the remedies provided under this warranty are your sole and exclusive remedy for any breach of our warranty and state the entire limit of our responsibilities.

Assembly Instructions

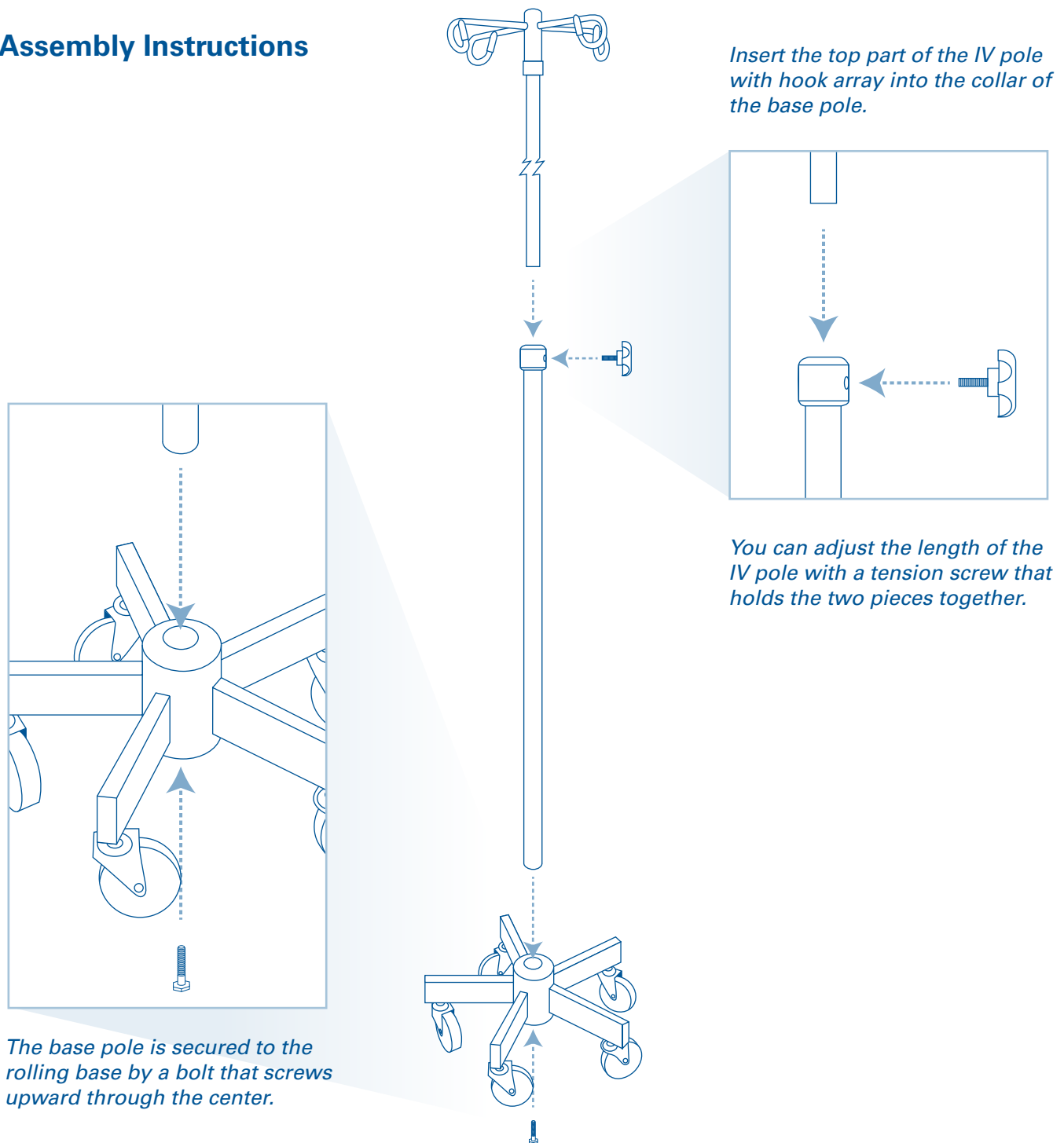

Direct Supply[®] Direct Choice[™] products are available to purchase exclusively through Direct Supply Equipment & Furnishings[®], a division of Direct Supply, Inc. Distributed by Direct Supply Manufacturing, Inc. 6699 N Industrial Road, Milwaukee WI 53223.

©2012 Direct Supply Manufacturing, Inc. All Rights Reserved. Direct Supply[®], Direct Choice[™], and all associated logos are the registered trademarks of Direct Supply Inc., used under license.