

### Components

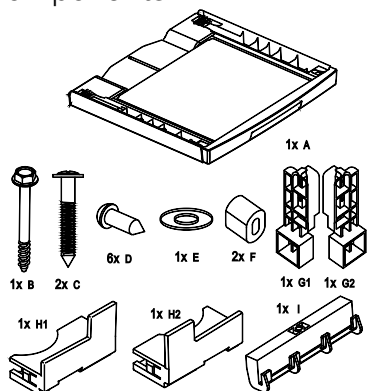

2

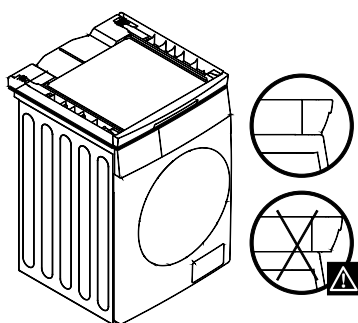

**⚠ CAUTION:** Ensure that the tray and washer edge are aligned.

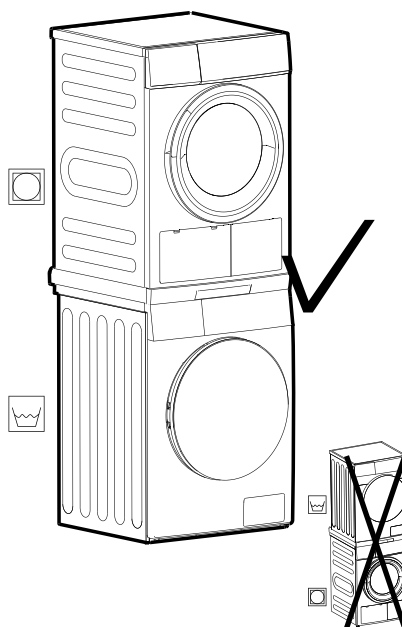

**⚠ WARNING:** do NOT stack washer on dryer.

1

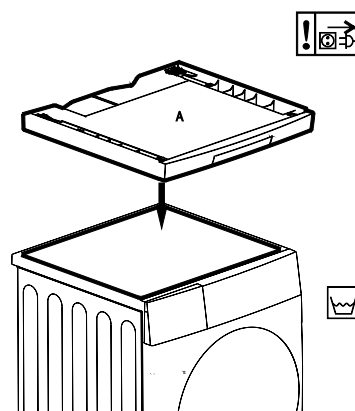

3

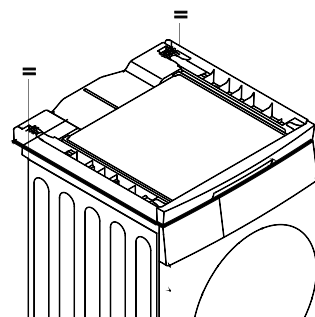

Make sure the tray and sides and back of the washer are aligned.

4

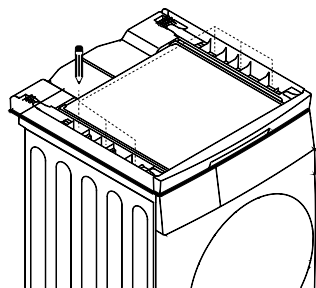

Mark the holes on the top of the washer.

5

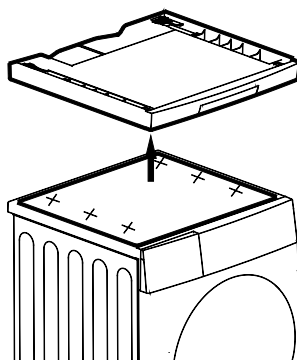

Remove the tray, revealing the marks from the previous step.

6

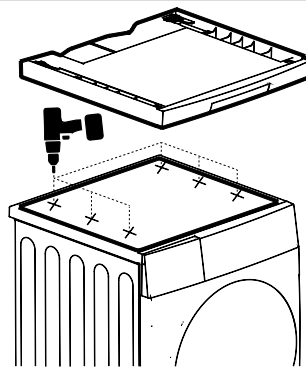

Using a 3mm drill bit, drill pilot holes 3-5mm into the top of the washer at the 6 marked locations.

7

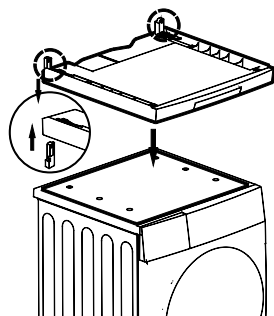

Attach the mounting brackets to the back of the tray. While facing the front of the unit, G1 should go on the rear left and G2 on the rear right. Do not fasten.

8

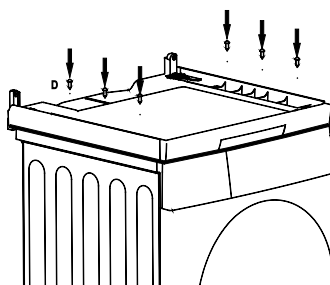

Securely fasten the D screws through the tray into the top of the washer.

9

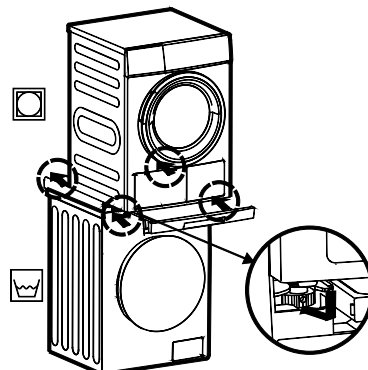

Lift the dryer off the ground and slide it through the slots in the tray.

10

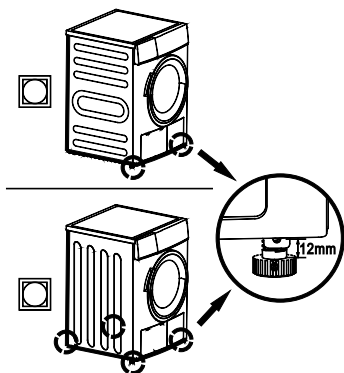

Screw or unscrew the dryer feet until they are about 0.5" tall or 12mm.

11

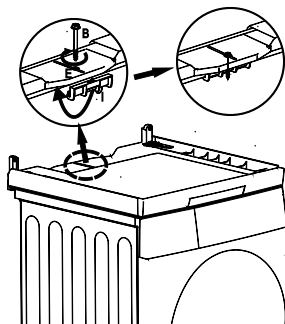

Pull back the handle on the back of the tray and place bolt B and washer E through the rear of the tray and securely fasten them. Push the handle back in when complete.

12

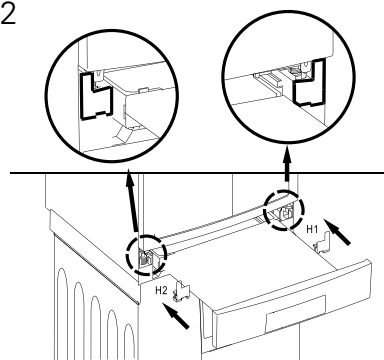

Place and secure brackets H1 and H2 into the front ends of the slots from the previous steps

13

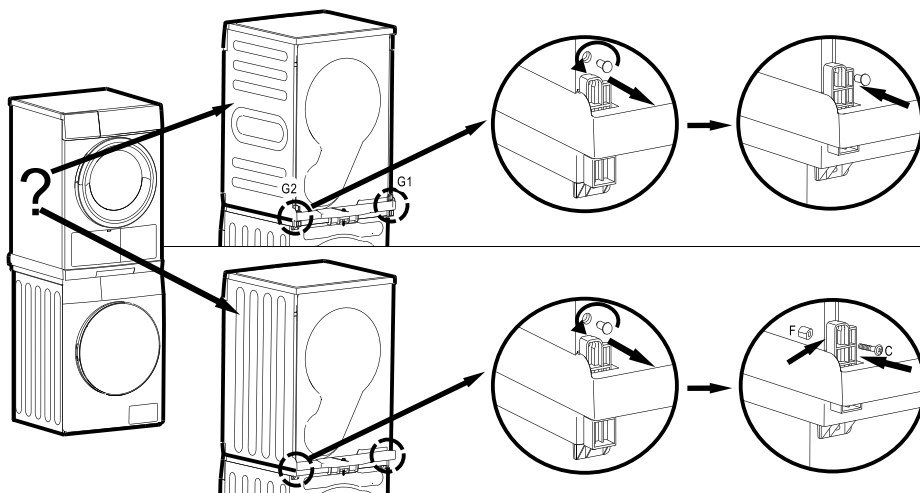

Remove the plug from the holes above the rear brackets, lift G1 and G2 up, and securely fasten them with spacer F and bolt C.

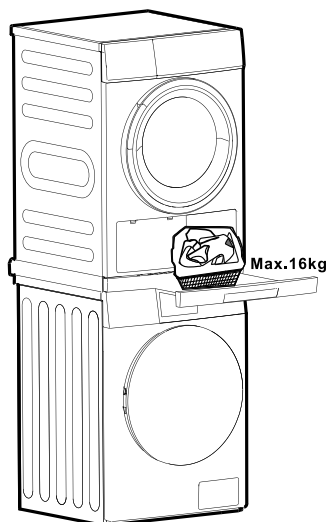

**⚠ WARNING:** Maximum weight is 35 lbs or 16 kg

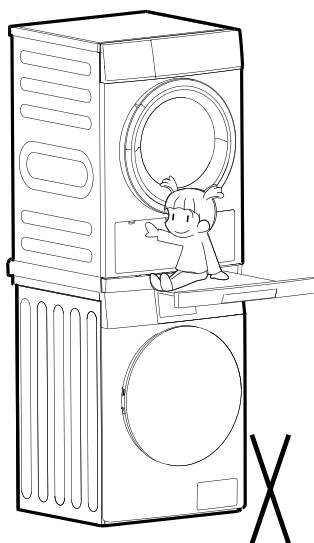

**⚠ WARNING:** Do not place your weight or climb onto the tray.

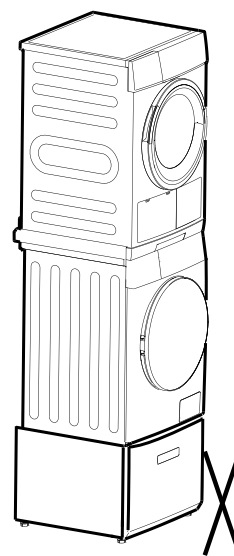

**⚠ WARNING:** do NOT stack washer and dryer on a pedestal or other mounting furniture.