



Panacea® TILT-IN-SPACE WHEELCHAIR

Owner's Manual

Please keep and refer to this Owner's Manual.

Thank you for purchasing a Panacea® Tilt-in-Space Wheelchair from Direct Supply Equipment & Furnishings®, a division of Direct Supply, Inc. Please read this entire guide carefully and keep it for future reference. This guide will provide you with instructions, warnings, warranty information and other important information about your Panacea® Tilt-in-Space Wheelchair. Share this information with your housekeeping, nursing and maintenance staff to help ensure the chair is used and cared for properly.

Table of Contents

Introduction2

Definitions & Symbols2

Warnings & Cautions3

Operating Instructions4 - 5

Care & Maintenance.....6

Technical Specifications7

Customer Service.....7

Limited Warranty8

Introduction

Thank you for purchasing the Panacea® Tilt-in-Space Wheelchair from Direct Supply Equipment & Furnishings®, a division of Direct Supply, Inc. In this owner’s manual, you will find important information you should read before using this device. Please keep this manual available for future reference. Should you have any questions, please contact your Direct Supply account manager.

This owner’s manual is compiled from the latest specifications and product information available at the time of publication. Changes may be made to this manual at any time. Contact Direct Supply for a current copy of this owner’s manual.

Definitions & Symbols

- ⚠ **WARNING:** Calls attention to a potential danger that requires correct procedures or practices in order to prevent personal injury.
- ⚠ **CAUTION:** Indicates correct operating or maintenance procedures in order to prevent damage to or destruction of the equipment or other property.
- 💡 **NOTE:** Indicates a helpful tip.
- 🛠 **DEVICE:** Your Panacea® Tilt-in-Space Wheelchair.
- 👤 **YOU and YOUR:** The facility, community, or other person or entity that has purchased the product.
- 🏢 **WE, US and OUR:** Direct Supply Manufacturing, Inc.
- ⚠ **Attention!** Read the instructions.

- Read and follow all directions and warnings before using this device. Do not operate this device without first reading and understanding this user manual. Damage, injury or even death may result from improper use of this device or not following directions and warnings. This device is intended for use under the supervision of trained and licensed healthcare or senior care providers in normal, indoor conditions.
- This device may not be appropriate for all individuals. A licensed healthcare professional should determine medical appropriateness on an individual basis. Check all parts for shipping damages before using. In case of damage, DO NOT use the equipment. Contact the Direct Supply Equipment and Furnishings for further instructions.
- ⚠ **WARNING:** Do not modify, remove or disable any feature, part or function of this wheelchair beyond the instructions in this manual. Do not use parts or accessories that are not designed for this device.
 - ⚠ **WARNING:** The combined weight of the user and any accessories mounted to the device must not exceed the weight capacity of this wheelchair. The weight capacity is 350 lbs.
 - ⚠ **WARNING:** Use extreme caution on any incline or decline. Proceed slowly to ensure a safe ascent or descent.
 - ⚠ **WARNING:** Never operate the device on public streets and roadways. Do not allow residents to operate this device unattended.
 - ⚠ **WARNING:** Never operate this device in rain, snow, salt, mist/spray conditions or on icy/slippery surfaces.
 - ⚠ **WARNING:** Make wide turns around corners. Always approach corners slowly, and do not allow residents to negotiate corners without assistance.
 - ⚠ **WARNING:** Do not use this device on any potentially hazardous incline or decline (i.e. areas covered with snow, ice, cut grass or wet leaves).
 - ⚠ **WARNING:** Do not allow more than one person to ride this wheelchair at a time.
 - ⚠ **WARNING:** Do not assist or allow residents to travel down an incline backward.
 - ⚠ **WARNING:** Use care when negotiating raised obstacles. It is not recommended to try to navigate obstacles higher than 2".
 - ⚠ **WARNING:** Do not use this wheelchair on steps or escalators. Always use an elevator.
 - ⚠ **WARNING:** Do not attempt to pick up the wheelchair while it is occupied by a resident.
 - ⚠ **WARNING:** Do not allow a resident to bend, lean or reach for objects while using this device. This may increase the likelihood of tipping and falling.
 - ⚠ **WARNING:** Make sure the resident’s hands, clothing and all other objects are clear of the wheels while the wheelchair is in motion.
 - ⚠ **WARNING:** Do not allow residents to transfer into or out of a wheelchair without assistance. Ensure residents do not put all of their weight on the wheelchair armrests, and do not use the armrests for weight-bearing purposes.
 - ⚠ **WARNING:** Ensure anti-tippers are always installed in the correct position when using the wheelchair.
 - ⚠ **WARNING:** NEVER lift the wheelchair by the armrests or front rigging.
 - ⚠ **WARNING:** Any change of seat depth may require repositioning of the rear wheels. Always test the stability of the chair before use.
 - ⚠ **WARNING:** NEVER stand on the footplates during transfers into and out of the wheelchair.
 - ⚠ **WARNING:** Ensure wheel locks are fully engaged while stopped on any incline/decline and while resident is transferring into and out of the wheelchair.
 - ⚠ **WARNING:** NEVER tilt the wheelchair on two wheels without assistance. When in any tilt or recline position, this chair must be operated by an attendant.
 - ⚠ **WARNING:** NEVER use the wheel locks to stop a moving wheelchair.
 - ⚠ **WARNING:** This device is not intended for motor vehicle use. Do not allow anyone to remain seated in the device while traveling in a motor vehicle. Do not use any kind of wheelchair tie-down restraints that are not approved by regulations.
 - ⚠ **CAUTION:** This device is designed primarily for indoor use. Do not use on rough surfaces.
 - ⚠ **CAUTION:** Do not attempt to lift or move the wheelchair by any of its removable parts, including the armrests, seat and front riggings. Do not attempt to pick up the wheelchair while the seat is occupied.
 - ⚠ **CAUTION:** Use care when operating the wheel locks. Possible pinch points created during operation.

Operating Instructions

Flip-Up Armrests

Engaging and Disengaging Armrest:

1. To engage, push armrest into arm socket until release lever (A) is engaged into slot.
2. For flip-up, push and hold release lever (A) while lifting armrest from arm socket.

Arm Height Adjustment:

1. Loosen knob (B).
2. Lift armrest until desired position is acquired (range is 9½" to 14" in ½" increments).
3. "Retighten" knob (B).

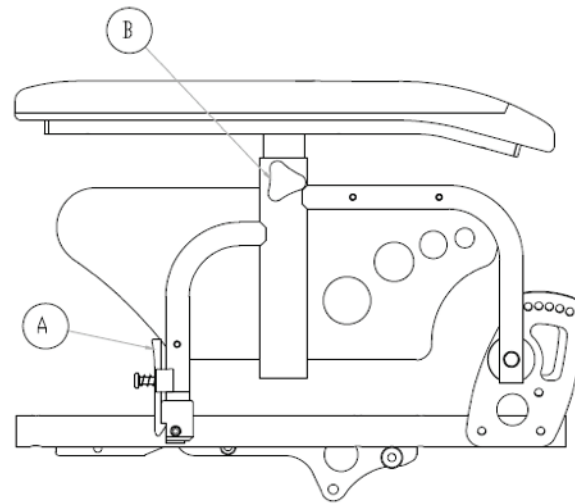

Footrests

Attaching Footrests:

1. Position swingaway legrest tabs onto pins (A), ensuring footplate is facing inward.

Footplate Adjustment:

1. Remove footrest bracket bolt (B). Slide footrest extension tube up or down to desired height.
2. "Retighten" bolt.

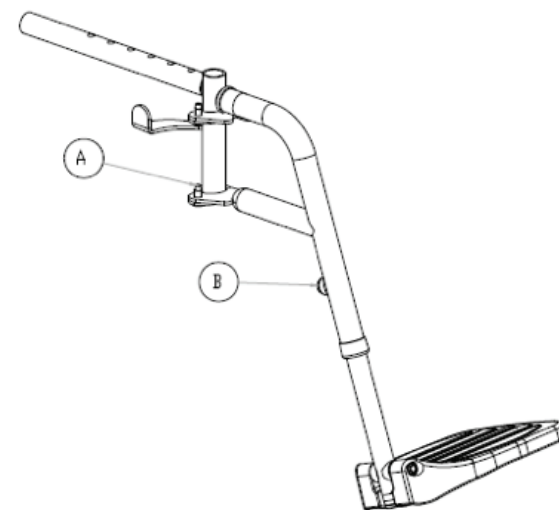

Back Canes

Back Angle Adjustment:

Manufacturer's setting is 90 degrees, with each hole representing 7-degree increments (holes range from 83 degrees to 111 degrees).

1. Remove nut and bolt (A) on both sides of the back post.
2. Move back cane to desired angle and replace nuts and bolts (A) making sure coved spacers are in place.

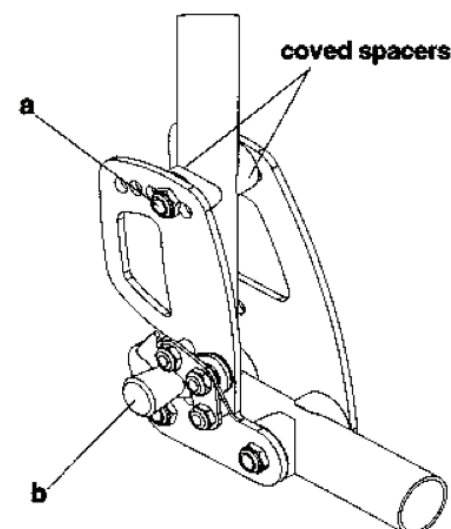

Folding Down Back for Transport:

1. Push up the knob (B) on the left side to disengage pin in the locked position.
2. Push and hold up the knob on the right side to release back post forward.
3. To return back to an upright position, lift up back posts, ensuring right side locks into place and pulling left knob out and down.

Rear Wheel

Rear Wheel Positioning:

1. To adjust wheelbase to maintain stability when altering seating system, remove rear wheel from axle plate and reinstall bushing in desired location (A).
2. Replace axle and nut and tighten, ensuring wheel spins freely without excessive lateral movement.

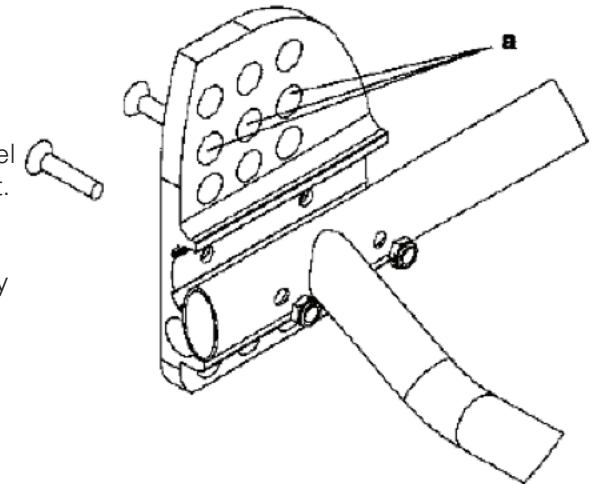

Wheel Lock Adjustment

1. Loosen both bolts attaching wheel lock assembly to frame.
2. Slide assembly along frame until wheel lock secures rear wheel firmly in the locked position.
3. "Retighten" bolts.
4. Repeat steps 1 to 3 for other side.

Transporting the Wheelchair

1. Remove the seating system (seat cushion, backrest, headrest).
2. Turn the anti-tippers to the upward position.
3. Remove the front rigging (footrests or elevating legrests).
4. Remove the armrests.
5. Remove rear wheels (if necessary).
6. Fold down back canes.

Securing Wheelchair with Tie-Down Points:

NOTE: The wheelchair may be equipped with four (4) tie-down points for the purpose of securing the unoccupied wheelchair during motor vehicle transport.

1. Always secure the wheelchair in a forward-facing position in the vehicle.
2. Attach the four tie-down straps only to designated points on the wheelchair frame.
3. Tighten the straps to sufficiently remove all slack.
4. Never attach tie-downs to adjustable, moving or removable parts of the wheelchair, such as armrests, front riggings and wheels.

⚠ WARNING: Do not allow anyone to remain seated in the device while traveling in a motor vehicle.

Transfers

⚠ WARNING: Use caution and make sure the wheelchair is stable during transfers.

⚠ WARNING: Do not use the armrests, wheel locks or front riggings for weight-bearing purposes during transfers. The armrests can be removed by pulling up on them if needed. The front riggings can be removed by releasing the trigger then pulling up the front rigging.

1. Ensure both wheel locks on your wheelchair are engaged.
2. If necessary, remove or flip up one or both armrests.
3. Move the legrests aside.
4. Reduce the distance between the resident's wheelchair and the place to which the resident is being transferred.
5. Always follow all policies set by your community for transfers.

Your Panacea® Tilt-in-Space Wheelchair requires routine maintenance checks. If assistance is required, contact Direct Supply. Preventive maintenance is very important. Following the maintenance checks in this section may help prolong the usable life of your wheelchair. Verify the device is correctly functioning prior to each use. **NEVER USE THIS DEVICE IF YOU SUSPECT IT MAY BE DAMAGED OR OTHERWISE OPERATING INCORRECTLY.**

Regular Inspections

- Check the seat for any visible damage.
- Check for loose or missing screws, nuts and bolts. Replace or tighten as necessary.
- Check the tires and casters for uneven wear, holes or tire/rim separation. Replace as necessary.
- Check the hand rims. Make sure they are fastened securely to the wheels. Tighten as necessary.
- Check the wheel locks. Make adjustments to the wheel locks to coincide with tire wear.
- Check the anti-tip wheels for wear or damage.
- Inspect gas cylinders for leaks or wear. Replace as necessary
- Inspect all cables and ensure they are free from kinks and operate freely. Replace as necessary.
- Verify smooth tilt function.
- Verify fasteners are tight. Tighten any loose connections, if necessary.
- Wash and wax the wheelchair frame to keep it free from excessive dirt and grease that might interfere with the operation of the chair.

Cleaning

- Use a damp cloth and mild, nonabrasive cleanser to clean the plastic and metal parts of your wheelchair. Avoid using devices that may scratch the surface of your wheelchair.
- Wipe off excess water with a dry cloth. Metal parts should be wiped completely dry after cleaning.
- If necessary, clean your device with a disinfectant. Make sure the disinfectant is safe for use before application.

Storage

Your Panacea® Tilt-in-Space Wheelchair should be stored in a dry place, free from temperature extremes. Avoid prolonged exposure to extreme conditions, such as heat, cold or moisture.

Technical Specifications

Tilt Range	0 to -45 degrees
Seat Width	16", 18", 20"
Seat Depth	16", 18"
Seat-to-Floor Height	16"
Back Cane Height	20"
Rear Wheel	24" Diameter, Mag Style
Caster Diameter	6" Diameter, Composite
Overall Dimensions (18" x 16" seat, 16" seat-to-floor height)	Length: 34.5" Width: 27.5" Height: 44"
Armrests	Flip-Back, Height-Adjustable Gel Arm Pads: 17"L x 2.5"W
Front Rigging Options	70-Degree Pin Style, Swingaway Footrest, Elevating Legrest
Footplates	Composite, Flip-Up, Heel Loops
Wheel Locks	Push-to-Lock
Rear Wheel Axle Mount	Bolt-On, Multi-adjustable Plate
Push Handles	Stroller Push Bar, Height Adjustable
Anti-Tippers	Flip-Up, Length Adjustable
Weight Capacity	350 lbs.
Weight of Device	65 lbs.

Customer Service

Our promise to you is that you will have a convenient and easy ordering experience, receive a quality Panacea® Tilt-in-Space Wheelchair and enjoy outrageous customer service. If you have any questions about the Tilt-in-Space Wheelchair you have purchased or would like to request warranty service, please contact: **Direct Supply Equipment & Furnishings** at 1-800-634-7328, 6767 N. Industrial Road, Milwaukee, WI 53223, SalesSupport@DirectSupply.com.

Limited Warranty

We, Direct Supply Manufacturing, Inc. offer to you, as the original purchaser, a warranty for the Panacea® Tilt-in-Space Wheelchair. Our warranty applies for the limited warranty period stated below. If any product or product part listed below is defective in material or workmanship during the applicable limited warranty period, we will repair or replace it at our cost. Please note that the decision to repair or replace a product or product part will be at our discretion.

Our warranty applies only if the product is properly maintained by the original purchaser for normal, indoor use and does not cover normal wear and tear, modification of the product or damage caused by abuse, improper use, failure to maintain, use which exceeds the published product limitations or the combination of any product with another product. In addition, our warranty does not cover fading, colorfastness, stains, spills or exposure to chemicals, odors, heat or light. In certain cases, we may provide you repair or adjustment instructions and/or replacement parts and ask you to perform a repair or adjustment or replace a defective part.

Our warranty gives you specific legal rights, and you may also have other rights, which vary from state to state. Please note that our limited warranty period begins when we ship the product to you. The limited warranty period and our obligations under the warranty end once you transfer the product to someone else or at the end of the applicable limited warranty period identified below, whichever is earlier.

Device	Warranty Period (Parts)	Anticipated Usable Product Life
Panacea® Tilt-in-Space Wheelchair Frame	Limited Lifetime	Limited Lifetime
Backrest Frame	3 years	3 years
Seat Cushion Foam Components	2 years	2 years
Nondurable Components/Hardware	1 year	1 year
Upholstery	90 days	1 year

Anticipated Usable Product Life is based on normal use with proper maintenance, cleaning and storage. You should still inspect, monitor and care for the product as described in this guide, as the product may need to be replaced sooner than anticipated in particular situations.

DIRECT SUPPLY MANUFACTURING, INC. MAKES NO IMPLIED WARRANTIES OF MERCHANTABILITY OR FITNESS FOR A PARTICULAR PURPOSE; THESE AND ALL OTHER IMPLIED WARRANTIES ARE SPECIFICALLY DISCLAIMED. TO THE FULLEST EXTENT ALLOWED BY LAW, DIRECT SUPPLY MANUFACTURING, INC. WILL NOT BE LIABLE FOR ANY INCIDENTAL, SPECIAL, CONSEQUENTIAL OR PUNITIVE DAMAGES, OR LOST PROFITS THAT MAY RESULT FROM THE PRODUCT OR YOUR USE OF OR INABILITY TO USE THE PRODUCT EVEN IF ADVISED OF THE POSSIBILITY OF SUCH DAMAGES. OUR TOTAL LIABILITY TO YOU, IF ANY, IS LIMITED TO THE PRICE OF THE PRODUCT OR SERVICE GIVING RISE TO YOUR CLAIM. Some states do not allow an exclusion or limitation of incidental or consequential damages, or how long an implied warranty lasts, so the above limitations or exclusions may not apply to you. If implied warranties are not excluded, and to the extent allowed by law, we limit any and all implied warranties to the applicable warranty period identified above. Except for rights under any applicable state law, the remedies provided under this warranty are your sole and exclusive remedy for any breach of our warranty and state the entire limit of our responsibilities.



DirectSupply.com

APTURA / EQUIPMENT & FURNISHINGS / DSSI / TELS

Distributed by Direct Supply Manufacturing, Inc. 6635 N Industrial Road, Milwaukee, WI 53223.

© 2017 Direct Supply Manufacturing, Inc. All Rights Reserved. Direct Supply®, Panacea®, and all associated logos are the registered trademarks of Direct Supply, Inc., used under license.