



Maxwell Thomas® MORNINGSIDE OVERBED TABLE

Assembly and Operating Instructions *Ensamblado de Mesa de Cama e Instrucciones de Uso*

⚠ Important Warnings

To avoid serious injury and/or death to a patient or resident, follow ALL instructions and these guidelines:

- This product is designed ONLY as patient/resident convenience as a surface for reading, eating or keeping small personal items, such as glasses, within reach.
- The weight limit for this product is 50 lbs. (22 kg); the weight should be evenly distributed over the top of the product's table.
NOTE: The hinged tabletop extension has a weight capacity of 10 lbs.
- Overloading this product could result in the product breaking as well as damage to property and/or serious injury.
- This product should NOT be used as a walker, to assist a person in sitting down or standing up, to prevent or brace a person's fall, or to transport persons. Use ONLY as directed.
- This product is designed for indoor use ONLY within close proximity of skilled caregivers. It is not designed to hold electrical items, such as televisions, and should be kept away from open flames and excessive heat.
- Inspect the product for damage before each use. DO NOT use the product if it appears to be damaged or unstable, and DO NOT alter the product in any way.
- DO NOT overtighten the screws or use power tools when assembling this product.
- The weight limit on the flip-up surface is 10 lbs.

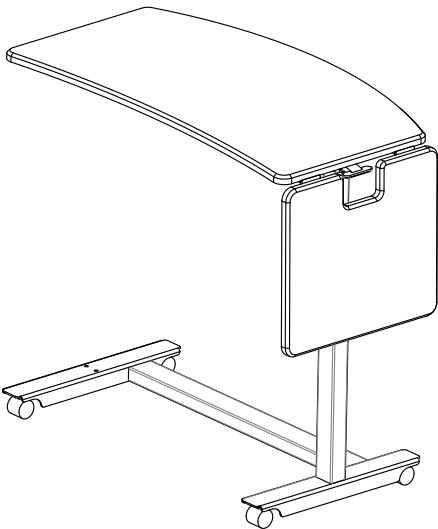

Tools Needed

Herramientas Necesarias

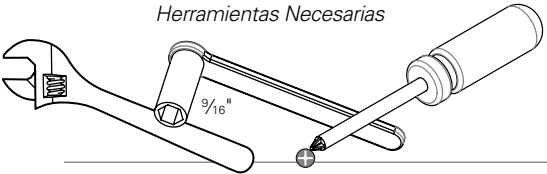

Components and Parts

Componentes y Piezas

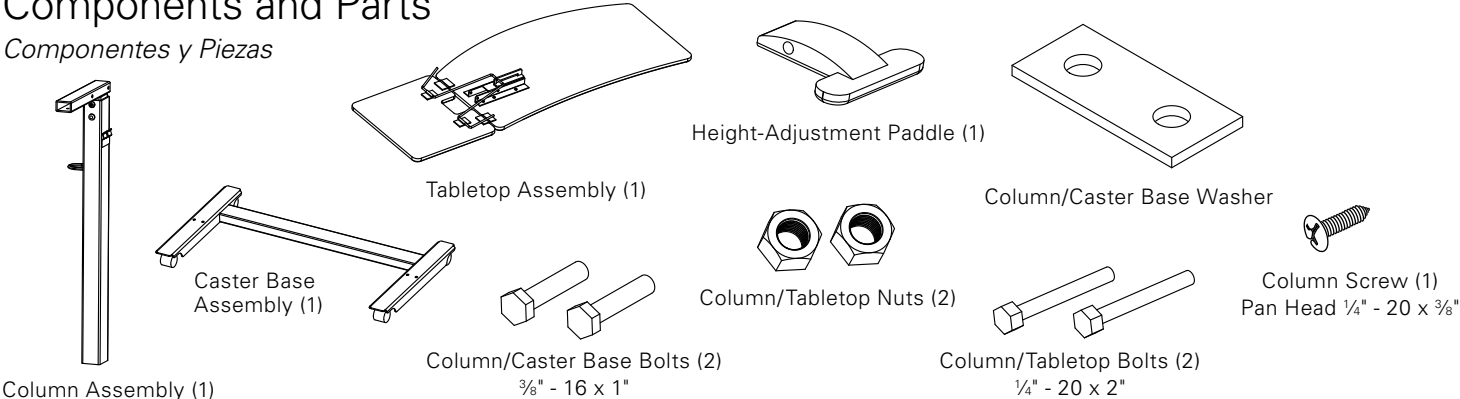

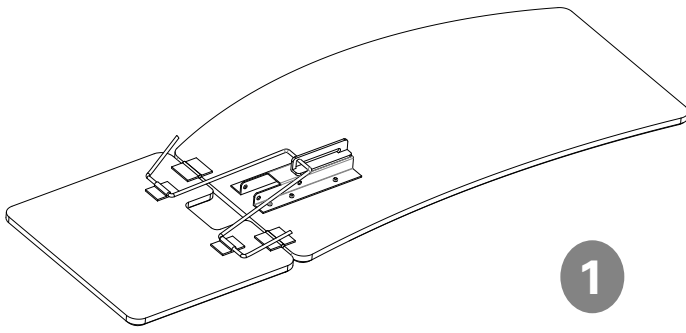

1

Place the overbed tabletop assembly so the hinge mechanism is facing upward. Be sure the top is protected to prevent scratches during assembly.



2

Position the overbed table column assembly so the 'T' is facing upward.

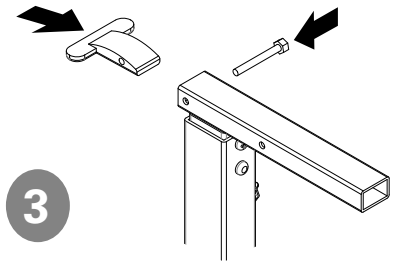

3

Place the height-adjustment paddle into the square tube, and insert one of the column/tabletop bolts through the tube and handle to temporarily hold it in place.

NOTE: The curved portion of the paddle must be facing upward.

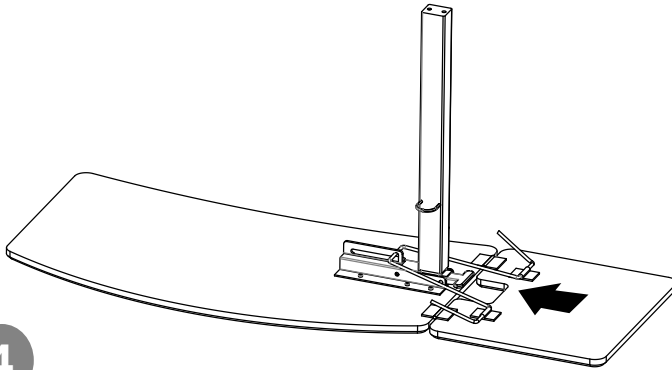

4

Position the overbed table column so the 'T' is facing downward, and make sure the height-adjustment paddle is in place. Insert the square tube of the column into the tabletop bracket of the tabletop assembly.

NOTE: The bolt holding the height-adjustment paddle in place will need to be removed when inserting the column bracket into the tabletop bracket – make sure the paddle stays in the same place when removing this bolt to prevent the spring mechanism pin from falling out.

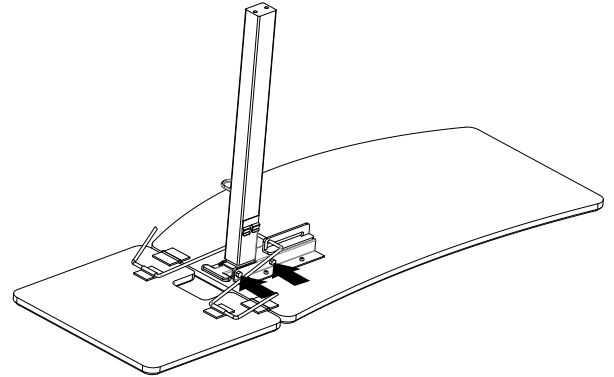

5

Insert the two tabletop bolts and tabletop nuts to secure the column and tabletop assemblies.

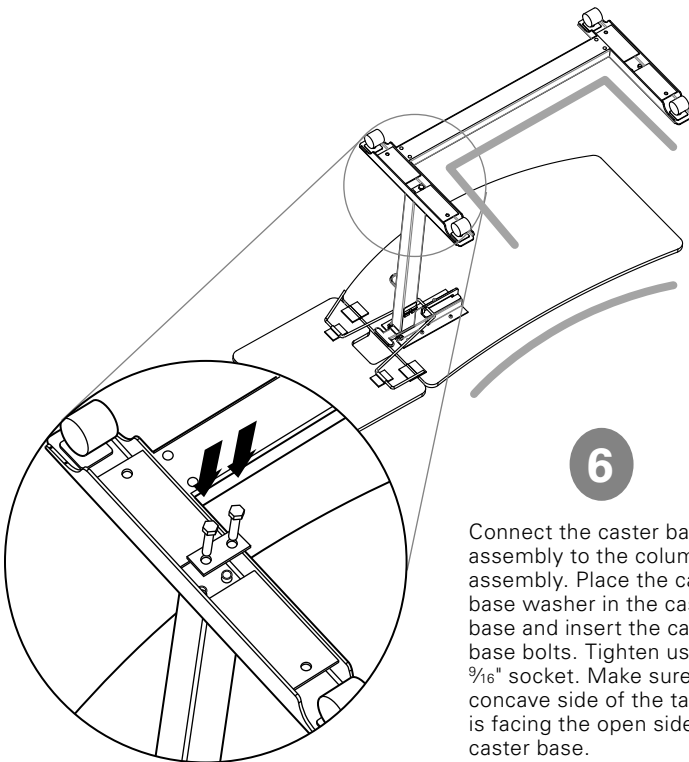

6

Connect the caster base assembly to the column assembly. Place the caster base washer in the caster base and insert the caster base bolts. Tighten using a $\frac{9}{16}$ " socket. Make sure the concave side of the tabletop is facing the open side of the caster base.

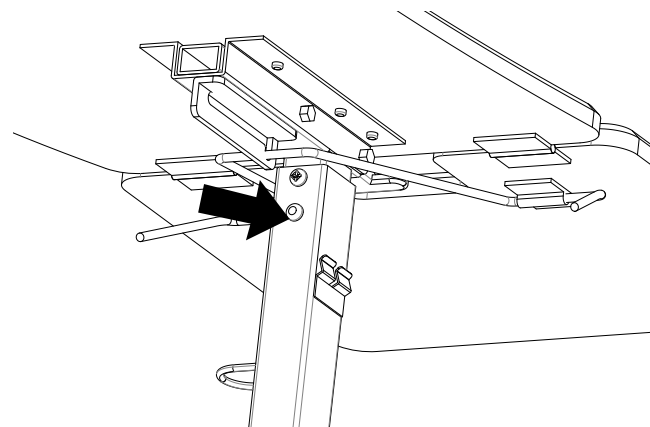

7

Once the overbed table is fully assembled, carefully place the overbed table on its casters. Remove the top screw from the column and discard it. Install the column machine screw into the upper hole of the outer column and tighten.

NOTE: The bottom screw MUST be left in place or it will need to be repaired by the manufacturer.

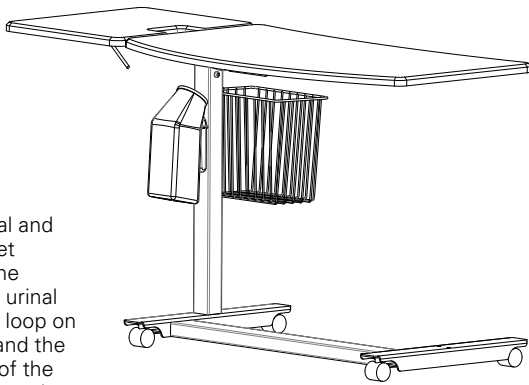

Optional urinal and storage basket installation: the handle of the urinal goes into the loop on the column, and the upper frame of the basket clips into the opposite side of the column.

NOTE: It is recommended to mount the basket by inserting the short side of the basket into the basket clips on the column. This will reduce the basket interference when used with a bed and allow the tabletop to go fully over a bed for the most usable surface for the resident. The basket can be mounted using the long side of the basket if it is more appropriate for your space needs.

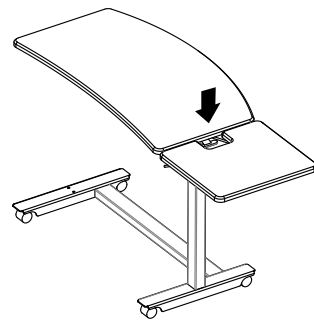

Use the cutout in the tabletop extension to access the height-adjustment paddle while the tabletop extension is up.

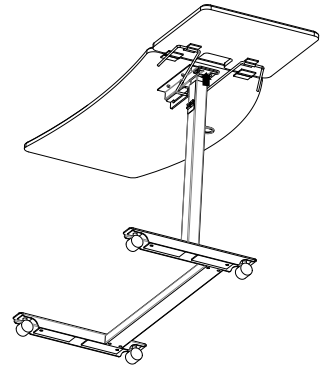

Gently lift the height-adjustment paddle upwards to adjust the height of the overbed table.

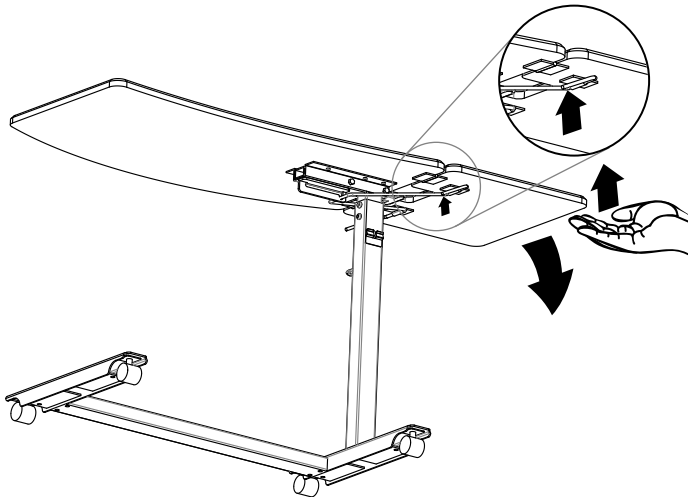

To lower the hinged tabletop extension, lift the hinged tabletop up slightly and pull upwards on the lever below the tabletop. Make sure you assist the hinged tabletop extension on its way down to prevent injury.

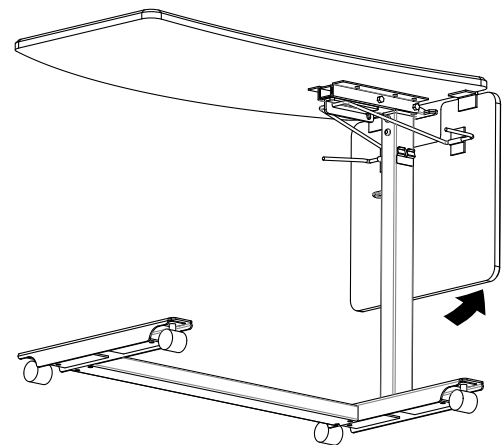

To raise the hinged tabletop extension pull upwards on the tabletop extension until the lock locking mechanism clicks in place.

Cleaning instructions:

MaxwellThomas thermolaminate overbed tabletops can be safely cleaned and disinfected with the following cleaners and disinfectants. In laboratory testing using both the NEMA LD 3.4 and ASTM D3450 test methods, these materials were shown to have no discoloration or damage to the finish when cleaned and disinfected with the products listed below and instructions provided on the cleaners and disinfectants are followed.

NOTE: It is important to remove excess moisture as soon as the product is cleaned and dwell time for disinfectant is complete.

- Asepticare TB-II
- Bleach 5:1
- Bleach-Rite® disinfecting spray
- Cavicide® surface disinfectant
- Citrace® germicide
- Clorox® germicidal wipes
- Dispatch® spray hospital cleaner disinfectant with bleach
- Fade-A-Dyne® stain remover
- Lyso® spray disinfectant
- Precise™ hospital cleaner
- PDI® Super Sani-Cloth® germicidal wipes
- PDI Sani-Cloth HB germicidal wipes
- PDI Sani-Cloth Plus germicidal wipes
- SaniZide Plus® germicidal solution
- Virex® II 256 cleaner
- Virox® AHP 5 disinfectant cleaner surface wipes

Other cleaning solutions, such as mild detergent and water, may be appropriate if they do not have higher concentrations of active ingredients.

⚠ CAUTION: Abrasive cleaners should never be used, as they may damage the surface.

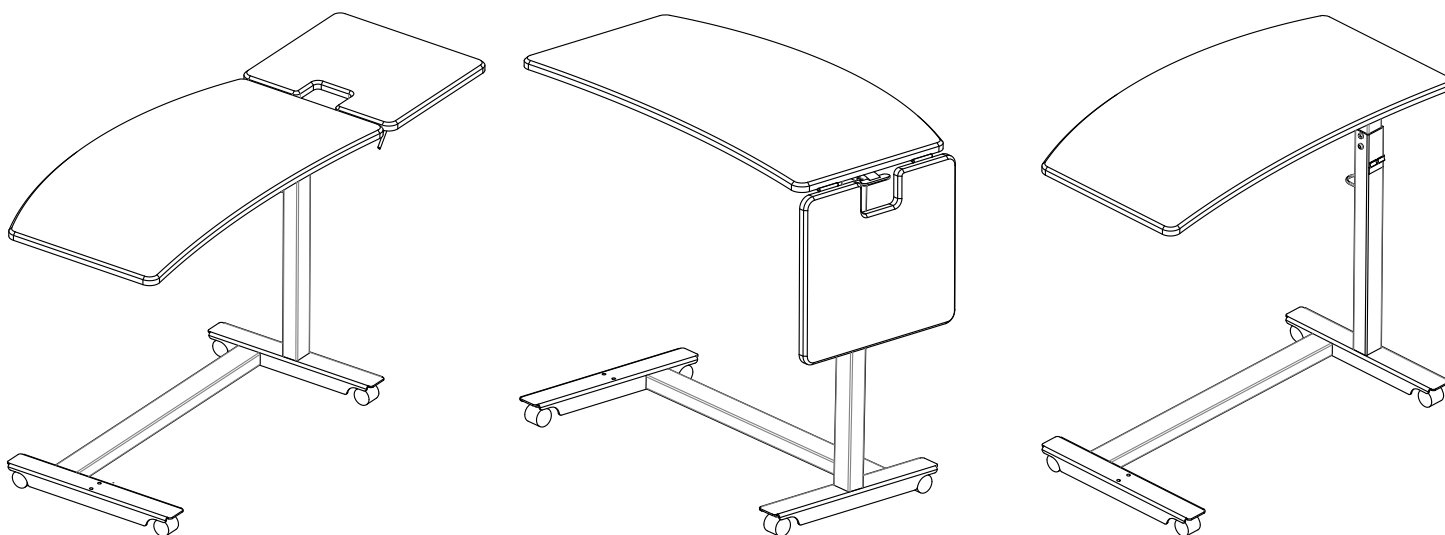

The Maxwell Thomas Overbed Table is also available without the hinged tabletop extension.

Customer Service

Our promise to you is that you will have a convenient and easy ordering experience, receive a quality overbed table and enjoy outrageous customer service. If you have any questions about the overbed table you have purchased or would like to request warranty service, please contact: **Direct Supply Equipment & Furnishings** at 1-800-634-7328, 6767 N. Industrial Road, Milwaukee, WI 53223, SalesSupport@DirectSupply.com.

Limited 1-Year Warranty

Direct Supply Manufacturing, Inc. warrants to you, as the original purchaser, for the limited warranty period stated above from the date we ship the product to you that we will repair or replace any product which is defective in material or workmanship. Please note that the decision to repair or replace a product will be at our discretion.

Our warranty applies only if the product is properly maintained by the original purchaser for normal, indoor use and does not cover normal wear and tear, modification of the product, or damage caused by abuse, improper use, failure to maintain, use which exceeds the published product limitations, or the combination of any product with another product. In addition, our warranty does not cover characteristics or natural variations in wood grain, colorfastness, stains, spills or exposure to chemicals, odors, heat or light. In certain cases, we may provide you repair or adjustment instructions and/or replacement parts, and ask you to perform a repair or adjustment or replace a defective part.

Our warranty gives you specific legal rights, and you may also have other rights, which vary from state to state. The limited warranty period and our obligations under the warranty end once you transfer the product to someone else or at the end of the applicable limited warranty period identified below, whichever is earlier.

DIRECT SUPPLY MANUFACTURING, INC. MAKES NO IMPLIED WARRANTIES OF MERCHANTABILITY OR FITNESS FOR A PARTICULAR PURPOSE; THESE AND ALL OTHER IMPLIED WARRANTIES ARE SPECIFICALLY DISCLAIMED. TO THE FULLEST EXTENT ALLOWED BY LAW, DIRECT SUPPLY MANUFACTURING, INC. WILL NOT BE LIABLE FOR ANY INCIDENTAL, SPECIAL, CONSEQUENTIAL OR PUNITIVE DAMAGES, OR LOST PROFITS THAT MAY RESULT FROM THE DEVICE OR YOUR USE OF OR INABILITY TO USE THE DEVICE EVEN IF ADVISED OF THE POSSIBILITY OF SUCH DAMAGES. OUR TOTAL LIABILITY TO YOU, IF ANY, IS LIMITED TO THE PRICE OF THE DEVICE OR SERVICE GIVING RISE TO YOUR CLAIM. Some states do not allow an exclusion or limitation of incidental or consequential damages, or how long an implied warranty lasts, so the above limitations or exclusions may not apply to you. If implied warranties are not excluded, and to the extent allowed by law, we limit any and all implied warranties to the applicable warranty period identified above. Except for rights under any applicable state law, the remedies provided under this warranty are your sole and exclusive remedy for any breach of our warranty and state the entire limit of our responsibilities.



DirectSupply.com

APTURA / EQUIPMENT & FURNISHINGS / DSSI / TELS

Distributed by Direct Supply® Manufacturing™, Inc., 6699 N Industrial Road, Milwaukee, WI 53223.

©2018 Direct Supply Manufacturing, Inc. All Rights Reserved. Direct Supply®, Maxwell Thomas®, and all associated logos are the registered trademarks of Direct Supply, Inc., used under license.

Date of Printing: July 2018 10583