



# ***Siderails and Assist Device for Direct Supply® Panacea® 1000 Adjustable-Height Low Beds***

## ***Owner's Manual***

Thank you for purchasing Siderails and Assist Device for Direct Supply® Panacea® 1000 Adjustable-Height Low Beds from Direct Supply Equipment & Furnishings®. Please read this entire guide carefully and keep it for future reference. This guide will provide you with instructions, warnings, warranty information and other important information about your Direct Supply Panacea Siderails and Assist Device. Share this information with your housekeeping, nursing and maintenance staff to help ensure the bed is cared for properly.

*Please keep and refer to this Owner's Manual.*

# Introduction

## Table of Contents

Bed System Entrapment Information .....	2
Assist Device Installation .....	3-4
Half-Rail Installation .....	5-6
Maintenance/Inspection Information.....	7-8
Warnings .....	9-10
Limited Warranty .....	11
Customer Service .....	12

## Definitions and Symbols

**NOTE:** Indicates a tip.

**CAUTION:** Indicates correct operating or maintenance procedures in order to prevent damage to or destruction of the equipment or other property.

**WARNING:** Calls attention to a potential danger that requires correct procedures or practices in order to prevent personal injury.

**DEVICE:** Direct Supply® Panacea® Siderails and Assist Device.

**YOU and YOUR:** The facility, community or other entity that has purchased the device.

**WE, US and OUR:** Direct Supply Manufacturing, Inc.

 Attention. Consult accompanying drawings.

## Bed System Entrapment Information

In April 1999, the U.S. Food and Drug Administration (FDA) in partnership with representatives from the hospital and post-acute bed industry, national healthcare organizations, patient advocacy groups, and other federal agencies formed the Hospital Bed Safety Workgroup (HBSW). The workgroup's goal is to improve the safety of bed frames for residents and patients in all health care settings who are most vulnerable to the risk of entrapment. The efforts of the FDA and the HBSW culminated in the FDA's release of recommended guidelines intended to reduce the risk of entrapment, including dimensional limits for critical gaps and spaces between bed system components and clinical guidance for assessment and implementation of bed siderails in various health care settings.

Entrapment zones involve the relationship of bed components often directly assembled by the healthcare facility rather than the manufacturer. Therefore, compliance is the responsibility of the facility.

# Assist Device Installation

## Attaching the F025P Assist Device to your Panacea 1000 Bed

### Parts List

Item	Part Number	Description	Qty
1		Assist Handle	1
2	12523167	Bolts	2
3	11012033	Space Tubes	2
4	12673105	Lock Nuts ( $\frac{5}{16}$ " - 18 Hex)	2
5	12843788	$\frac{3}{8}$ " Flat Washers	2
6	12843789	$\frac{5}{16}$ " Flat Washers	2

*Suggested Tools:  $\frac{7}{16}$ " Deep Well Socket with ratchet,  $\frac{1}{2}$ " Socket Wrench,  $\frac{3}{8}$ " Torque Wrench*

1. Remove the plugs from positions A and B on the mattress deck.

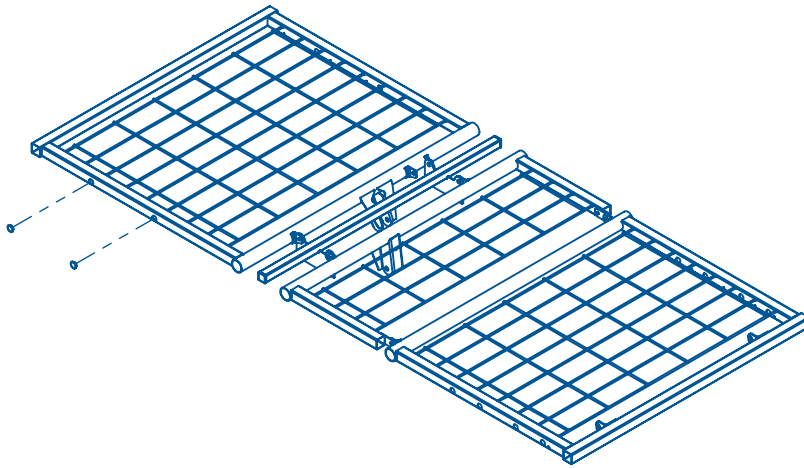

Remove plugs as shown, and attach the siderails or assist device in holes A and B on the head end of the bed.

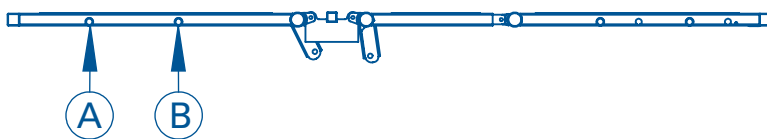

# Assist Device Installation (cont.)

2. Place the bushings (Item 3) in the large mounting holes (Figure 2).
3. Place bolts (Item 2) along with  $\frac{5}{16}$ " washers (Item 6) through holes in assist handle (Item 1) (Figure 3).
4. Put bolts through the bushings (Item 3). Place  $\frac{3}{8}$ " washer (Item 5) over the bolt (Item 2) and thread nut (Item 4) on the bolt (Item 2) and torque to 17 lbs-ft. Refer to Figures 3 and 4.

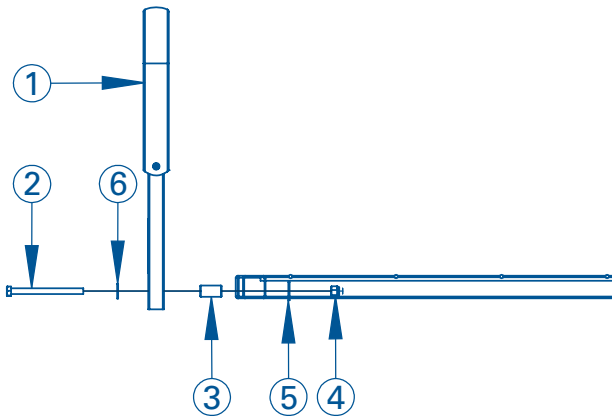

Figure 2

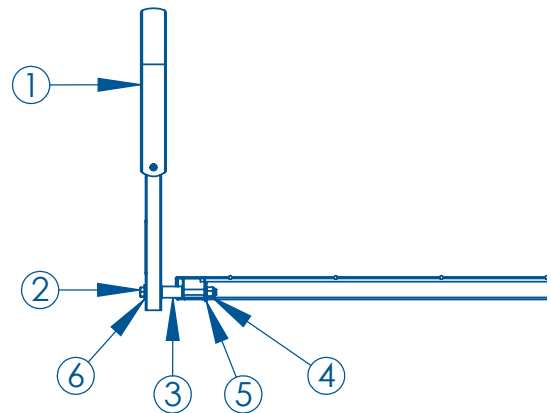

Figure 3

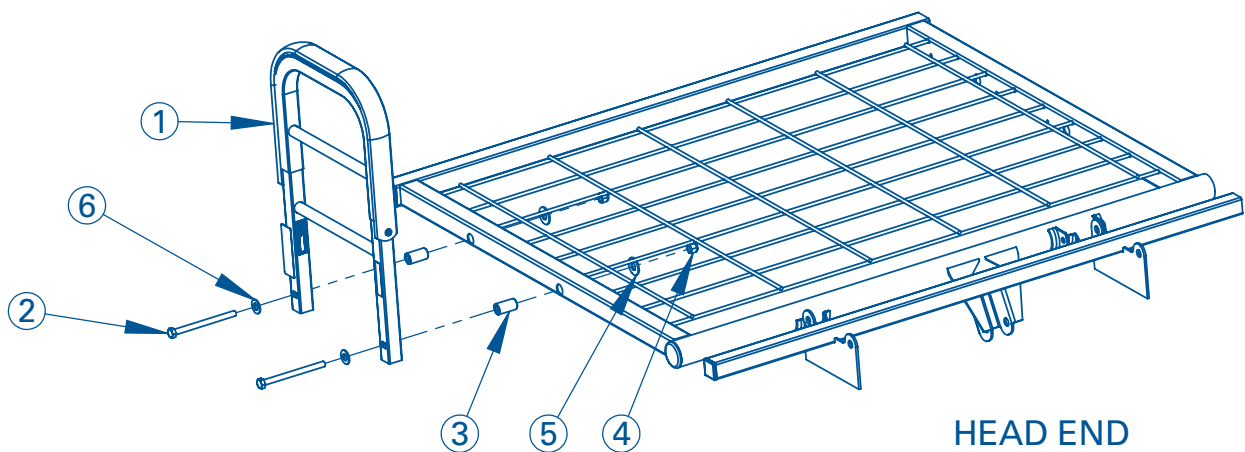

Figure 4

# Half-Rail Installation

## Attaching the F14SCP Siderail to your Panacea 1000 Bed

1. Remove the plugs from positions A and B on the mattress deck
2. Insert the siderail in holes A and B.
3. Attach mounting clips from the bed to the siderail

When mounted to the bed, the latch must always face the center of the bed

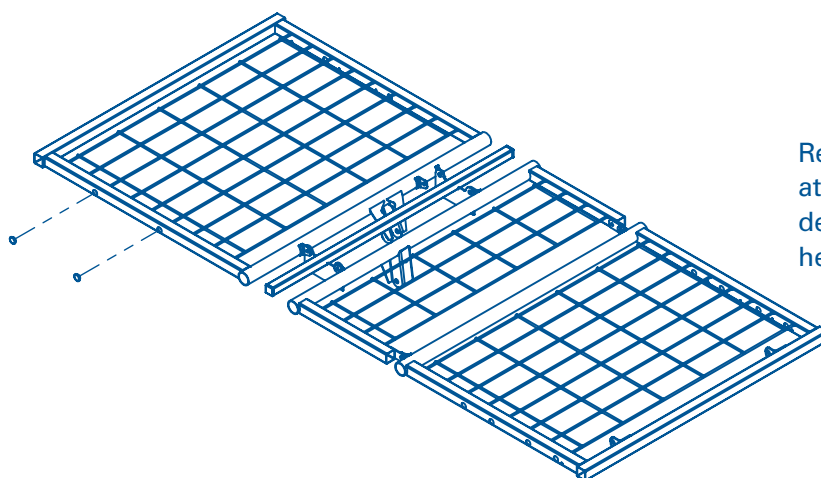
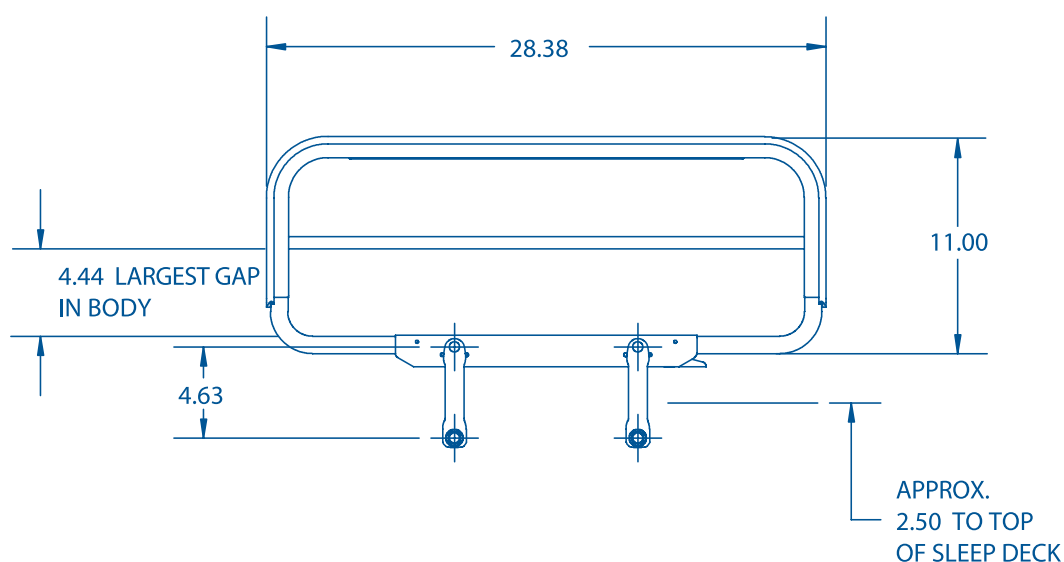

Remove plugs as shown, and attach the siderails or assist device in holes A and B on the head end of the bed.

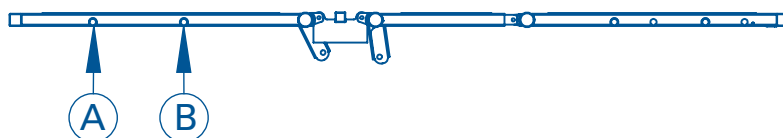

## ***Maintenance/Inspection Information***

Visually inspect the assist handle and mounting bracket, and check for loose hardware on a monthly basis. Tighten loose hardware as stated in the installation instructions.

**NOTE:** Assist devices are made for right or left side of bed as viewed from the foot of the bed. The latch on both assist devices must face toward the center of the bed, so they operate properly.

# Warnings

**⚠ WARNING:** Risk of Serious Injury or Death. These products are intended only for use with the Direct Supply Panacea 1000 Adjustable-Height Low bed. Never use these products on any other bed; the use of this product with any other bed could result in an unproven or unsafe configuration, potentially resulting in serious injury or death.

**⚠ WARNING:** Risk of Serious Injury or Death. Use a properly sized mattress in order to minimize the gap between the side of the mattress and the Direct Supply Panacea assist device or siderail. This gap must be small enough to prevent a resident from getting his/her head or neck caught in this location. Make sure that raising or lowering the bed, or adjusting the sleep surface, does not create hazardous gaps. Failure to do so could result in serious injury or death.

**⚠ WARNING:** Risk of Serious Injury or Death. Properly locate the mounting brackets. The gap between the head/foot panel and the Direct Supply Panacea assist device or siderail must be small enough to prevent a resident from getting his/her head or neck caught in this location (see the installation instructions for more information, if applicable). If multiple assist devices are needed, position them such that the gap between them is large enough that the trunk and hips can easily pass through. Make sure that raising or lowering the bed, or adjusting the sleep surface, does not create hazardous gaps. Direct Supply Panacea assist devices or siderails should not be used if ANY openings within the bed system allow a resident to get his/her head or neck lodged within these openings. Failure to do so could result in serious injury or death.

**⚠ WARNING:** Risk of Serious Injury or Death. Do not use the Direct Supply Panacea assist device as an assist until you have verified that it is up AND locked. Injury to resident or caregiver may result if this procedure is not followed.

**⚠ WARNING:** An optimal bed system assessment should be conducted on each resident by a qualified clinician or medical provider to ensure maximum safety of the resident. The assessment should be conducted within the context of, and in compliance with, the state and federal guidelines related to the use of restraints and bed system entrapment guidance, including the Clinical Guidance for the Assessment and Implementation of Side Rails published by the Hospital Bed Safety Workgroup of the U.S. Food and Drug Administration. Further information can be obtained at the following web address: <http://www.fda.gov/MedicalDevices/ProductsandMedicalProcedures/GeneralHospitalDevicesandSupplies/HospitalBeds/default.htm>

**NOTE:** The Direct Supply Panacea assist devices are intended for use as an aid in entering or exiting the bed sleep area, as well as a stable handhold during self positioning within the sleep area.

**NOTE:** The Direct Supply Panacea siderails are intended to provide a physical indication of the bed edge, as well as a stable handhold during self positioning within the sleep area.

Direct Supply Panacea assist devices or siderails are designed to be used with specific Direct Supply Panacea bed frames. Once mounted on the appropriate bed frame, assist devices or siderails become an integral part of the Direct Supply Panacea bed system. As such, these mounted assist devices or siderails can handle the same safe working load, within normal use conditions, of the appropriate bed to which they are mounted.

## **Warnings** (cont.)

A licensed healthcare provider should investigate the potential risk for entrapment on an individual basis. When assessing the risk for entrapment, consider your bed, mattress, head/foot panels, assist devices and other accessories, as a system. It is also extremely important to review the resident's physical and mental condition and initiate an appropriate individual care plan to address entrapment risk.

Direct Supply Panacea Siderails and Assist Devices should be assembled, installed, utilized and maintained in the manner described in their accompanying Direct Supply Panacea User/Service Manual. Read this manual and the accompanying bed manual in full prior to using this product. The instructions for use of these devices also list the bed type or model with which they may be used.

 **WARNING:** Some states may prohibit siderails or consider siderails to be patient restraints. Always assess whether restraints are necessary on a case-by-case basis and document the need for any patient restraint. Contact your state surveyor for further guidance regarding siderails and restraints.

*This product is only one part of your healthcare bed system. Proper combinations of mattress, head/foot panels and assist devices are needed to minimize the risk of entrapment.*



# Limited Warranty

We offer to you, as the original purchaser, a warranty for the Direct Supply Panacea Siderails and Assist Device. Our warranty applies for the limited warranty period stated below. If any device or device part listed below is defective in material or workmanship during the applicable limited warranty period, we will repair or replace it at our cost. Please note that the decision to repair or replace a device or device part will be at our discretion. Our warranty applies only if the device is properly maintained by the original purchaser for normal, indoor use and does not cover normal wear and tear, modification of the device or damage caused by abuse, improper use, failure to maintain, use which exceeds the published device limitations or the combination of any device with another product. In addition, our warranty does not cover fading, colorfastness, stains, spills or exposure to chemicals, odors, heat or light. In certain cases, we may provide you repair or adjustment instructions and/or replacement parts, and ask you to perform a repair or adjustment or replace a defective part.

Our warranty gives you specific legal rights, and you may also have other rights, which vary, from state to state. Please note that our limited warranty period begins when we ship the device to you. The limited warranty period and our obligations under the warranty end once you transfer the device to someone else, or at the end of the applicable limited warranty period identified below, whichever is earlier.

	Warranty Period (Parts Only)	Anticipated Usable Device Life
Siderails and Assist Device	3 years	3 years

Anticipated Usable Device Life is based on normal use with proper maintenance, cleaning and storage. You should still inspect, monitor and care for the device as described in this guide, as the device may need to be replaced sooner than anticipated in particular situations.

DIRECT SUPPLY MANUFACTURING, INC. MAKES NO IMPLIED WARRANTIES OF MERCHANTABILITY OR FITNESS FOR A PARTICULAR PURPOSE; THESE AND ALL OTHER IMPLIED WARRANTIES ARE SPECIFICALLY DISCLAIMED. TO THE FULLEST EXTENT ALLOWED BY LAW, DIRECT SUPPLY MANUFACTURING INC. WILL NOT BE LIABLE FOR ANY INCIDENTAL, SPECIAL, CONSEQUENTIAL OR PUNITIVE DAMAGES, OR LOST PROFITS THAT MAY RESULT FROM THE DEVICE OR YOUR USE OF OR INABILITY TO USE THE DEVICE EVEN IF ADVISED OF THE POSSIBILITY OF SUCH DAMAGES. OUR TOTAL LIABILITY TO YOU, IF ANY, IS LIMITED TO THE PRICE OF THE DEVICE OR SERVICE GIVING RISE TO YOUR CLAIM. Some states do not allow an exclusion or limitation of incidental or consequential damages or how long an implied warranty lasts, so the above limitations or exclusions may not apply to you. If implied warranties are not excluded, and to the extent allowed by law, we limit any and all implied warranties to the applicable warranty period identified above. Except for rights under any applicable state law, the remedies provided under this warranty are your sole and exclusive remedy for any breach of our warranty and state the entire limit of our responsibilities.



1-800-634-7328 ■ [directsupply.com](http://directsupply.com)

## *Customer Service*

Our promise to you is that you will have a convenient and easy ordering experience, receive quality Direct Supply® Panacea® Siderails and Assist Device for Direct Supply Panacea 1000 Adjustable-Height Low Beds, and enjoy outrageous customer service. If you have any questions about the equipment you have purchased or would like to request warranty service, please contact: **Direct Supply Equipment & Furnishings** at 1-800-634-7328, 6767 North Industrial Road, Milwaukee, WI 53223, [deardirect@directsupply.net](mailto:deardirect@directsupply.net).

Distributed by Direct Supply Manufacturing, Inc. 6699 N Industrial Road, Milwaukee, WI 53223.

© 2012 Direct Supply Manufacturing, Inc. All Rights Reserved. Direct Supply®, Panacea®, and all associated logos are the registered trademarks of Direct Supply, Inc., used under license.

**Taking Cost Out of Healthcare®**

