



Direct Supply® **ATLAS FLOOR LIFT**

Owner's Manual

Please keep and refer to this Owner's Manual.

Thank you for purchasing a Direct Supply® Atlas Floor Lift from Direct Supply Equipment & Furnishings®. Please read this entire guide carefully and keep it for future reference. This guide will provide you with instructions, warnings, warranty information and other important information about your lift. Share this information with your housekeeping, nursing and maintenance staff to help ensure the lift is cared for properly.

Table of Contents

Introduction	3
Important Safeguards	3
Definitions & Symbols	3
Safety.....	4 - 7
General Guidelines	4
Operating Guidelines	4 - 7
Positioning & Pinch Points	4
Lift Assembly	5
Lift Operation.....	5
Using the Sling	5
Lifting the Resident	5
Transferring the Resident.....	6
Performing Maintenance	6
Electrical & Grounding	6
Disposal.....	7
Radio Frequency Interference.....	7
Product Labeling.....	8
Assembly	9 - 10
Unpacking	9
Instructions.....	9 - 10
Mounting the Battery Charger	10
Operation	11 - 13
Hand Control Buttons	11
Raising/Lowering the Boom	11
Opening/Closing the Legs	11
Emergency Release.....	12
Emergency Stop.....	13
Charging the Battery.....	13
Lifting the Resident	14
Positioning the Resident Lift.....	14
Attaching a Sling.....	14
Lifting/Moving the Resident	14
Transferring The Resident.....	15 - 16
Transferring to a Commode Chair.....	15
Transferring to a Standard Commode	15 - 16
Transferring to a Bathing Unit	16
Transferring to a Wheelchair	16
Maintenance	17 - 20
Safety Inspection Checklist	17 - 18
Lift Lubrication	18
Detecting Wear & Damage.....	19
Cleaning the Sling & Lift	19
Boom Actuator Replacement.....	19
Mast Pivot Bolt	19
Cradle/Hanger Bar	20
Base Adjustment	20
Caster Replacement	20
Troubleshooting.....	21
Technical Data	22
Resident Lift	22
Limited Warranty	23
Customer Service	24

Introduction

Important Safeguards

⚠ WARNING: When using battery-operated mechanical products, especially when children are present, basic safety precautions should always be followed. Read all instructions before using and save for future reference. Important information is highlighted by these terms:

⚠ WARNING: This device is intended for indoor use under the supervision of licensed healthcare professionals. Use this device only as instructed. May not be appropriate for all individuals.

Definitions & Symbols

NOTE: Indicates a tip.

CAUTION: Indicates correct operating or maintenance procedures in order to prevent damage to or destruction of the equipment or other property.

WARNING: Calls attention to a potential danger that requires correct procedures or practices in order to prevent personal injury.

DEVICE: Atlas Floor Lift

YOU and YOUR: The facility, community or other entity that has purchased the device.

WE, US and OUR: Direct Supply Manufacturing, Inc.

⚠ Attention. Read the instructions.

Safety

General Guidelines

⚠ WARNING: Do not install, assemble or operate this equipment without first reading and understanding the instruction manual. If you are unable to understand the warnings, cautions or instructions, contact a healthcare professional, dealer or technical personnel before attempting to use this equipment. Otherwise, damage or injury could occur.

THE INFORMATION CONTAINED IN THIS DOCUMENT IS SUBJECT TO CHANGE WITHOUT NOTICE.

⚠ WARNING: Before using this product, check all parts for shipping damage. If the product is damaged, do not attempt to use it. Contact the provider for guidance.

Operating Guidelines

⚠ WARNING: This lift is not intended to transport a resident. It is intended only to transfer the resident from one surface to another, such as from a bed to a commode. Injury or damage may occur if not used as intended.

⚠ WARNING: Do not attempt to transfer a resident without prior approval from a medical professional. Do not install, assemble or operate this equipment without first reading and understanding the instruction manual and observing trained specialists perform a lift.

⚠ WARNING: People with disabilities must be watched closely when lifted.

⚠ WARNING: Only slings and accessories specifically designed for use with Direct Supply resident lifts should be used. Use of other manufacturers' components or accessories may compromise the operation of this resident lift.

⚠ WARNING: If the resident lift becomes wet or exposed to extreme temperature or humidity prior to use, ensure handgrips do not twist on resident lift handle. Damage or injury could occur.

Positioning & Pinch Points

⚠ WARNING: A pinch point is a place where it's possible for a body part to be caught either between moving mechanical parts or between moving and stationary parts of the product. Pinch points exist on this product between the boom and Cradle/Hanger bar and also at the base of the lift. When operating the lift, be aware of the Cradle/Hanger bar position relative to the resident. Injury could occur.

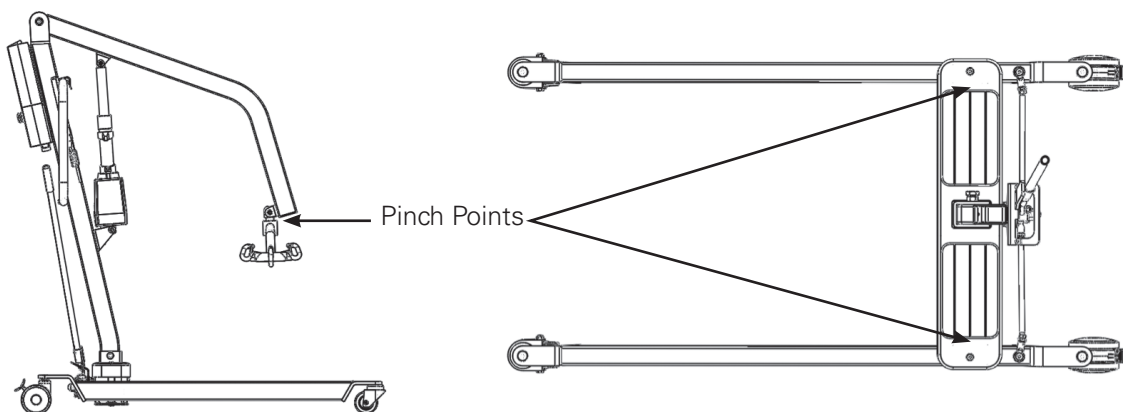

Lift Assembly

⚠ **WARNING:** DO NOT overtighten hardware. Product damage may occur.

Lift Operation

⚠ **WARNING:** More than one assistant is recommended for all resident lift activities.

⚠ **WARNING:** When mounting the battery on the charger, listen for an audible click to confirm proper mounting. Otherwise, damage or injury could occur.

⚠ **WARNING:** DO NOT exceed 450 lb. weight capacity.

⚠ **WARNING:** Keep clear of moving parts to avoid injury.

Using the Sling

⚠ **WARNING:** For proper comfort and safety, use only a sling made for this resident lift and recommended by a medical professional.

⚠ **WARNING:** DO NOT use any type of material between the resident and sling that may cause the resident to slide out of the sling during transfer.

⚠ **WARNING:** DO NOT modify slings in any way. Before each use, check sling attachments to ensure proper connection.

⚠ **WARNING:** If the resident is in a wheelchair, activate wheel locks to prevent chair from moving during transfers.

⚠ **WARNING:** After each use or wash, inspect sling(s) for wear, tear and loose stitching. Bleached, torn, cut, frayed or broken slings are unsafe and could result in injury. Discard and replace immediately.

⚠ **WARNING:** When connecting slings equipped with color-coded straps to the resident lift, the shortest straps MUST be at the back for proper support. The loops of the sling are color-coded and can be used to help place the resident in various positions. The colors make it easier for you to connect both sides of the sling equally. Always ensure the resident's head is properly supported during lifts.

Lifting the Resident

⚠ **WARNING:** Before lifting the resident, ensure legs on adjustable base lift are in the full open/locked position.

⚠ **WARNING:** After elevating the resident a few inches above stationary object, ensure the sling and all attachments are secure and properly connected. If any attachments are not properly in place, lower the resident back onto the stationary object and correct this problem. Adjustments for safety and comfort should be made before moving the resident. Be sure the resident's arms are inside straps.

⚠ **WARNING:** Use of other manufacturers' components or accessories may compromise the operation and are not to be utilized as a component of this resident lift system. The warranty will be voided.

⚠ **WARNING:** During transfers with the resident suspended in a sling attached to the lift, DO NOT roll caster base over uneven surfaces that could cause the resident lift to tip over. Use steering handle on the mast at all times to push or pull the resident lift.

⚠ **WARNING:** When lifting a resident, DO NOT lock the rear casters. Doing so could cause the lift to tip and could injure the resident or assistants. The rear casters should be left unlocked during lifting to allow the resident lift to stabilize itself when the resident is initially lifted from a chair, bed or any stationary object.

Safety *(cont.)*

Transferring the Resident

⚠ WARNING: After elevating the resident a few inches above stationary object, ensure the sling and all attachments are secure and properly connected. If any attachments are not properly in place, lower the resident back onto the stationary object and correct this problem.

⚠ WARNING: Before lowering the resident into wheelchair, be sure wheel locks are in a locked position.

⚠ WARNING: Before transferring, ensure the resident's weight does not exceed the 450 lb. weight capacity of the resident lift.

⚠ WARNING: Be sure to check the sling attachments each time the sling is removed and replaced to ensure it is properly attached before the resident is lifted from the bed or chair.

⚠ WARNING: Ensure mast is securely fastened for safety. All resident lift nuts, bolts and other attachments must be checked at least every six months in conjunction with periodic maintenance.

Performing Maintenance

⚠ WARNING: Maintenance MUST be performed ONLY by qualified personnel.

⚠ WARNING: Ensure proper resident lift operation by performing regular maintenance. DO NOT overtighten hardware. Product damage may occur.

⚠ WARNING: After the first six months of operation, inspect all pivot points and fasteners for wear. If the metal is worn, the parts MUST be replaced. Inspect these parts every six months thereafter.

⚠ WARNING: After the first year of use, inspect the hooks of the Cradle/Hanger bar and the boom mounting brackets every three months. Replace worn out parts as necessary. Inspect these parts every six months thereafter.

⚠ WARNING: Casters and axle bolts must be inspected every six months to check for tightness and wear. NEVER use a resident lift if you suspect any portion of it is damaged or worn.

Electrical & Grounding

⚠ WARNING: GROUNDING INSTRUCTIONS

The included battery charger should always be properly grounded to ensure resident and assistant safety. For this reason, this device is equipped with a three-prong grounding plug to prevent possible shock hazards.

⚠ WARNING: DO NOT alter, cut or remove the round grounding prong from this product. If a two-prong wall receptacle is encountered, it is the customer's responsibility to have the receptacle replaced by a qualified electrician with a properly grounded three-prong wall receptacle in accordance with the National Electrical Code and all local codes. If you must use an extension cord, use ONLY a three-wire extension cord having the same or higher electrical rating as the device being connected, and verify the extension cord is permitted in your community.

⚠ WARNING: RED warning tags are located on the device. DO NOT remove these tags. Carefully read battery/battery charger information prior to installing, servicing or operating your resident lift.

Disposal

⚠ WARNING: This product has been supplied from an environmentally aware manufacturer that complies with the Waste Electrical and Electronic Equipment (WEEE) Directive 2002/96/CE.

⚠ WARNING: This device contains lead acid batteries. DO NOT dispose of batteries in normal household waste. They MUST be taken to a proper disposal site. Contact your local waste management company for information. This product may contain substances that could be harmful to the environment if disposed of in places (landfills) that are not appropriate according to legislation.

Radio Frequency Interference

⚠ WARNING: Most electronic equipment is influenced by Radio Frequency Interference (RFI). CAUTION should be exercised with regard to the use of portable communication equipment in the area around such equipment. If RFI causes erratic behavior, PUSH the red power switch OFF IMMEDIATELY. DO NOT turn the power switch ON while transmission is in progress.

Product Labeling

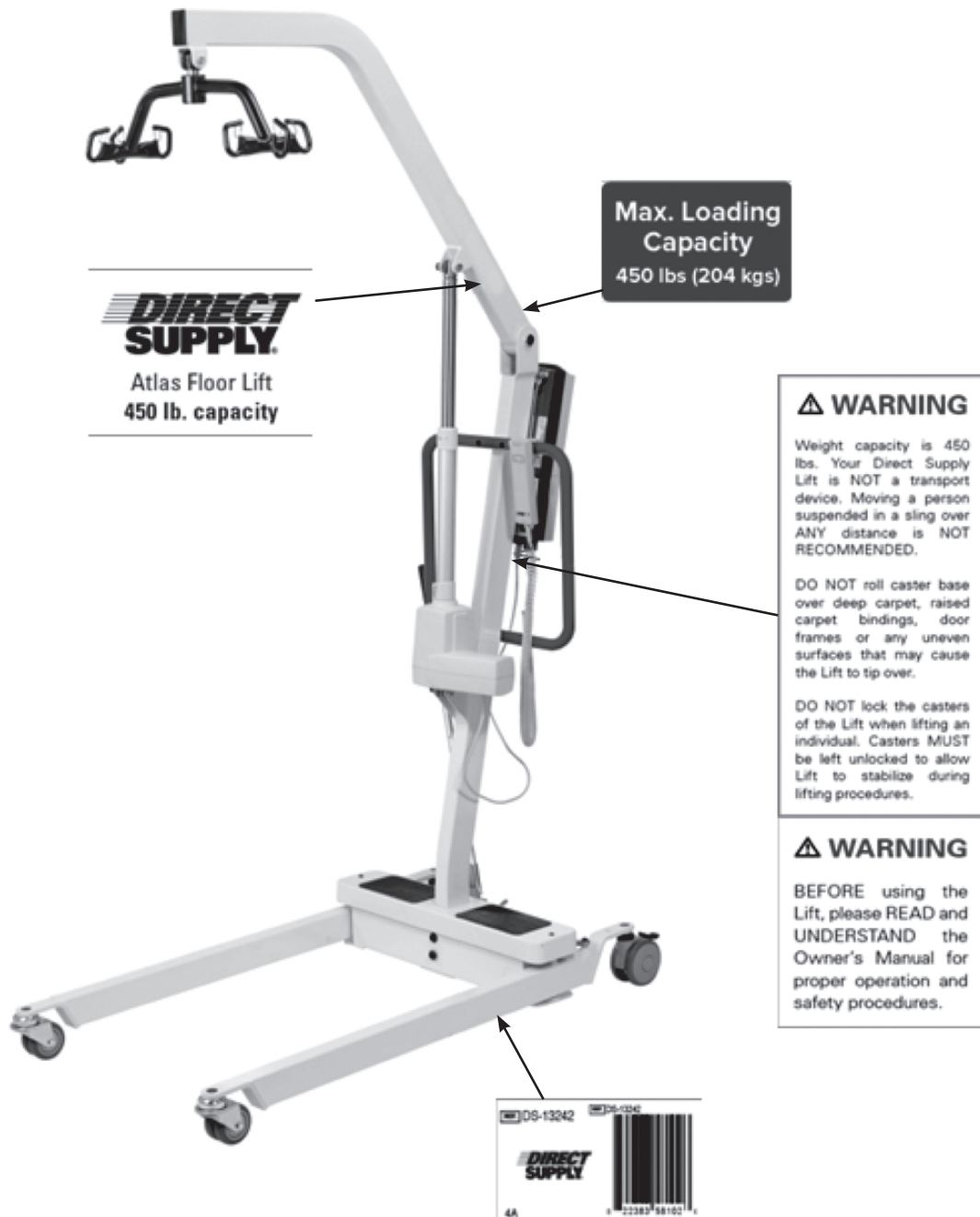

Assembly

⚠ WARNING: Only components specifically designed for use with Direct Supply resident lifts should be used.

Unpacking

Carefully unpack the components from the shipping carton:

- a) Mast with boom already assembled included Jumbo actuator (1 each)
- b) Base (1 each)
- c) Base spreading adjustment handle (1 each)
- d) Jumbo set – battery box (2 each), control box and control handset (1 each)
- e) “C” shaped push bars (2 each)
- f) 4/6 point cradle (1 each)

Assembly Instructions:

- a) Remove the two hex screws (A), washers (B) and bolt (C) from the base as indicated.
- b) With the boom pointed in the same direction as the base legs, insert the mast (D) into the mast sleeve and ensure the mast is in place.
- c) Install the two hex screws (A), washers (B) and bolt (C) on to the mast (D) through mast sleeve.
- d) Install the push handles (E, F) into the reserved position of the mast (D) and ensure the screws (G) are screwed tightly.
- e) Unscrew the gold-colored screw (H) from the mounting bracket (I) located behind the mast (D).
- f) Mount the Jumbo control box (K) on the mounting bracket (I) and screw back the bolts (J) on the bottom of the bracket.
- g) Place and clip the Jumbo battery pack (L) onto the top of the mounting bracket (I).
- h) Insert the base spreading adjustment handle (M) into the socket located behind the mast sleeve and use a hex screw to secure in place.
- i) Attach the cradle (N) to the end of the boom and make sure the bolts are screwed tightly.
- j) Test all functions and inspect all assemblies for proper operation.
- k) The resident lift is ready to use.
- l) Read this entire manual. Contact Direct Supply if you have any questions regarding the proper assembly or use of this device.

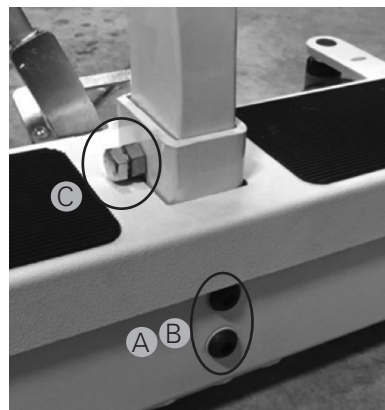
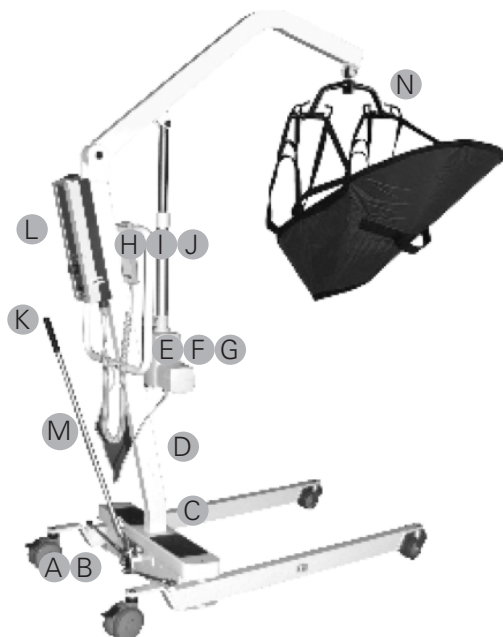

Assembly *(cont.)*

⚠ CAUTION: DO NOT overtighten hardware. Product damage may occur.

Be sure the bolt is completely through the holes of the boom assembly mounting bracket and the actuator assembly. The boom assembly will pivot easily if the mounting hardware is aligned properly when the boom assembly is secured to the mast.

Mounting the Battery Charger

Refer to your local regulations concerning proper mounting procedures.

- a) Place the battery charger with mounting bracket on the wall at the desired position.
- b) Mark the middle hole position with a pencil.
- c) Measure down 6½" from the pencil mark and drill one mounting hole.
- d) Install the bottom mounting screw until there is an approximate ⅛" gap between the screw head and the wall.
- e) Install the battery charger with the mounting bracket onto the bottom mounting screw.
- f) Drill the remaining two mounting holes.
- g) Install the two remaining mounting screws through the mounting bracket and into the wall. Tighten securely.
- h) Plug the battery charger into the wall electrical outlet.
- i) Verify ON is illuminated.

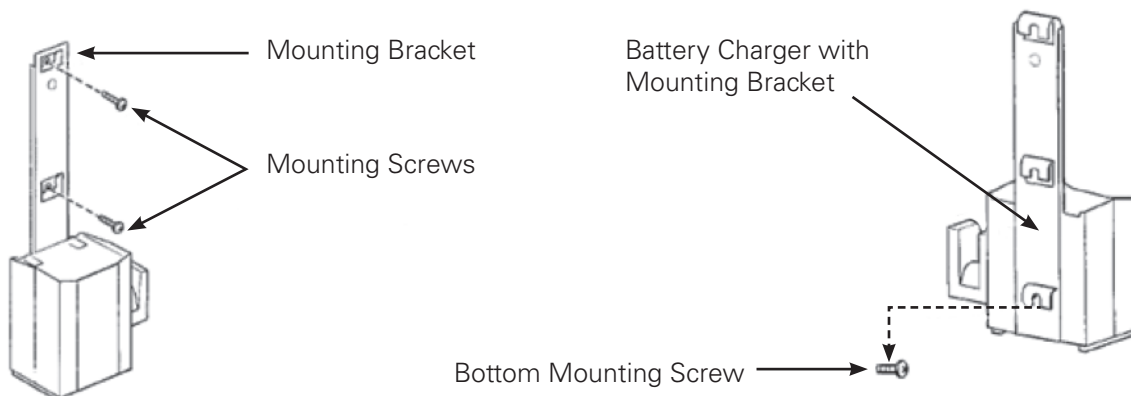

Operation

⚠ WARNING: Do not attempt to transfer the resident without prior approval from a medical professional. Do not install, assemble or operate this equipment without first reading and understanding the instruction manual and observing trained specialists perform a lift.

⚠ WARNING: When lifting a resident, the legs of the lift must be in the maximum open position for stability and safety. If it is necessary to close the legs of the lift to maneuver the lift under a bed, close the legs of the lift only as long as it takes to position the lift over the resident and lift the resident off the surface of the bed. Return the legs of the lift to the maximum open position when the legs of the lift are no longer under the bed.

⚠ CAUTION: More than one assistant is recommended for all resident lift activities.

Hand Control Buttons

Use the up/down buttons on your lift's hand pendant to raise and lower the lift's boom.

⚠ WARNING: When lifting a resident, DO NOT lock the rear casters. Doing so could cause the lift to tip and could injure the resident or assistants. The rear casters should be left unlocked during lifting to allow the resident lift to stabilize itself when the resident is initially lifted from a chair, bed or any stationary object.

Raising/Lowering the Boom

Press the boom up arrow to raise the boom and resident.
Press the boom down arrow to lower the boom and resident.

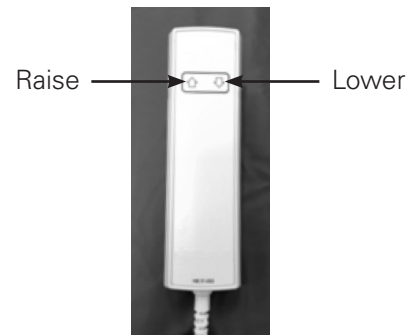

Opening/Closing the Legs

Opening and closing the legs requires the use of the spreader bar.

The spreader bar handle (M) is used to open the legs of the base for stability before lifting the resident. The base legs should be locked in the maximum open position at all times when the resident is on the lift.

⚠ WARNING: For maximum stability, operate this lift with the base legs in the fully open and locked position when lifting the resident.

To open the base legs, grasp the spreader bar handle (M) in one hand and place the opposite hand on the steering handle of the mast for balance. Move the handle toward you and away from the locking plate and then to the far left to open the base legs. To close the legs to a narrow position for transport or storage, reverse the above procedure.



Operation *(cont.)*

Emergency Release

Always use extreme caution when operating an emergency release.

Primary Emergency Release

To activate the primary emergency release, insert a pen into the hole labeled “emergency” on the control box of the lift and push down on the boom at the same time.

This product’s lift actuator is equipped with a mechanical emergency release, which enables retraction without electrical power. The actuator will only retract when the emergency release lever is pulled while under load. Locate the emergency release red-colored grip lever.

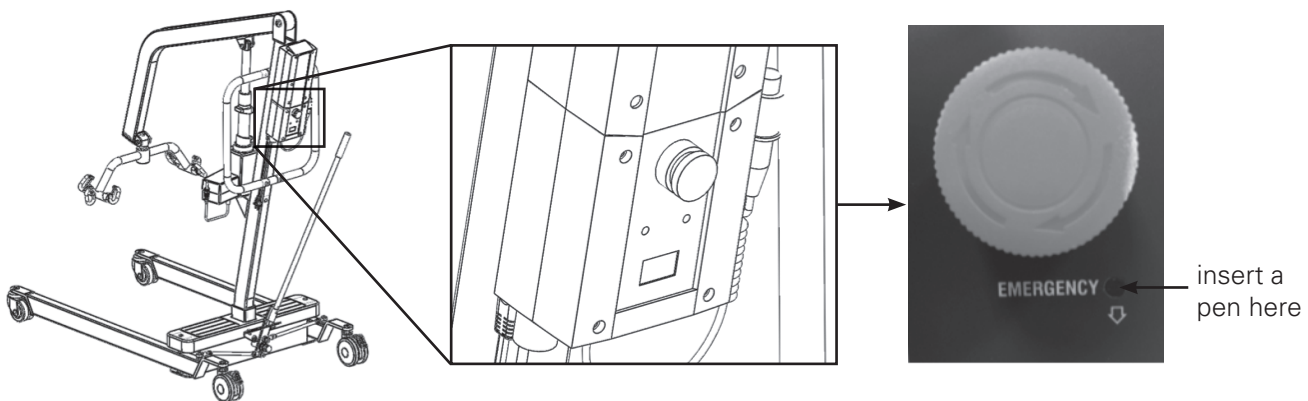

Secondary Emergency Release

⚠ CAUTION: The secondary emergency release is only a backup if the primary emergency release fails. Use the primary release first.

If the primary release fails to function correctly or is out of reach, the secondary emergency release may be used.

To activate the secondary release, pull up on the red-colored emergency release lever to the MAX position, which is about 11 mm, or when the red-colored lever can't be pulled up any further, and push down on the boom at the same time. Continue to lift the red emergency release lever to its maximum position, and push down on the boom until the boom has been fully lowered.

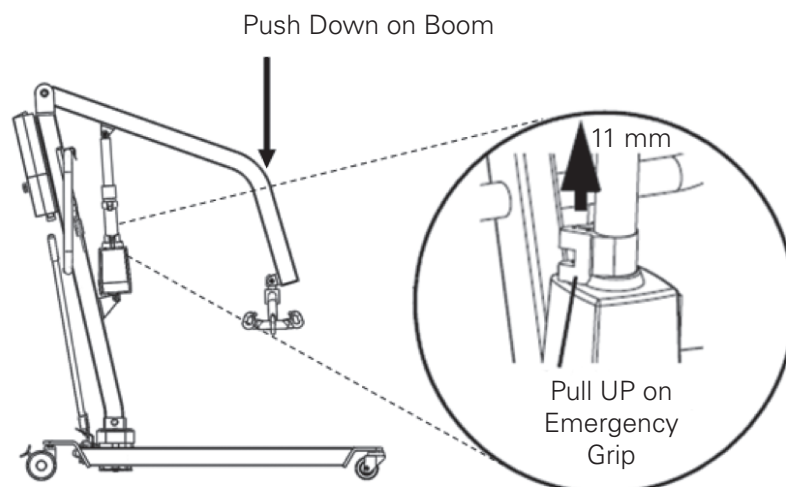

Emergency Stop

To stop the boom assembly from raising or lowering, press the red emergency button on the control box.

To disengage the emergency stop, rotate the red emergency stop button clockwise.

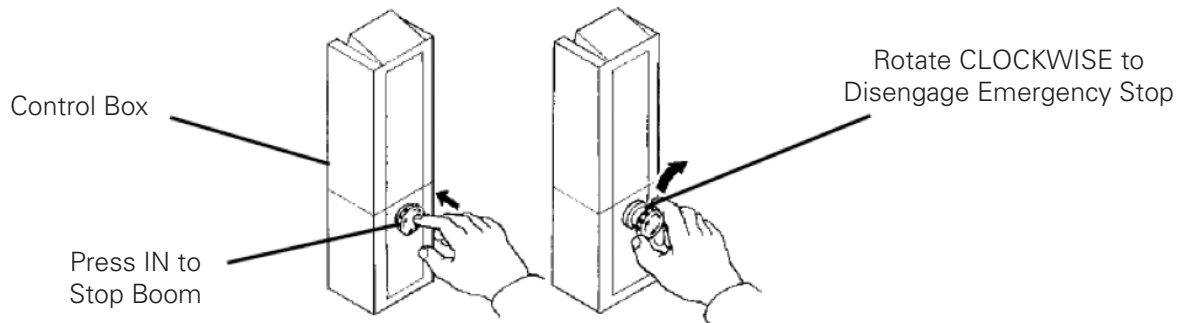

Charging the Battery

Attaching battery to unit:

- Lift the handle on the back of the battery.
- Lift the battery up and away from the control box.
- Place the battery on the battery charger as shown. Listen for an audible click.
- Lift the handle on the back of the battery.
- Lift the battery up and away from the battery charger.
- Reinstall the battery onto the control box as shown. Listen for an audible click.

To prolong battery life, the battery should be recharged daily. When the battery is low, an alarm will sound.

⚠ CAUTION: To confirm proper mounting, listen for a click when mounting the battery on the battery charger. Otherwise, damage may occur.

When the battery is charging, the charge LED will illuminate. When charging is complete, charge LED will stop illuminating. It takes approximately four hours for a battery to fully recharge.

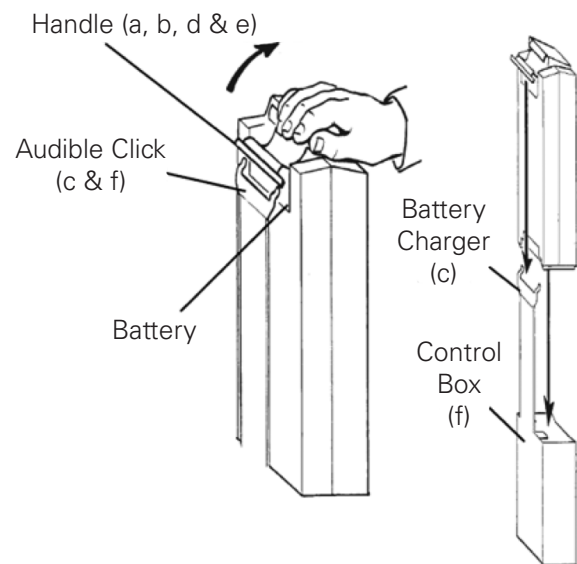

NOTE: The battery mounts to the control box and battery charger as shown.

Lifting the Resident

More than one assistant is recommended for all resident lift activities.

Positioning the Resident Lift

Refer to the Safety section in this manual before proceeding further and observe all warnings indicated. Before positioning the legs of the resident lift under a bed, make sure the area is clear of any obstructions.

⚠ WARNING: When lifting a resident, the legs of the lift must be in the maximum open position for stability and safety. If it is necessary to close the legs of the lift to maneuver the lift under a bed, close the legs of the lift only as long as it takes to position the lift over the resident and lift the resident off the surface of the bed. Return the legs of the lift to the maximum open position when the legs of the lift are no longer under the bed and lock the shifter handle.

- a) Use spreader adjustment handle (right to left) to open the legs of the resident lift to maximum width.
- b) Use the steering handle to position the resident lift.
- c) To lower the boom for easy attachment of the sling, press the boom down button on the hand control.

Attaching a Sling

- a) Place the straps of the sling over hooks of the Cradle/Hanger bar.
- b) Match the corresponding colors on each side of the sling.
- c) Use the lift. Refer to Lifting/Moving the Resident section.
- d) Direct Supply Lift Cradle/Hanger bars have three hookup points per side. The middle hookup is ONLY used for slings that have three sets of straps per side.

Lifting/Moving the Resident

- a) Press the boom UP arrow to raise the resident high enough to clear the bed. The resident's weight will be fully supported by the resident lift.
- b) Place the resident's arms inside the sling.
- c) When the resident is clear of the bed surface, swing the resident's feet off the bed.
- d) Use the steering handle to move the resident lift away from the bed.
- e) When moving the resident lift away from the bed, turn the resident so he or she faces the assistant operating the resident lift.
- f) Press the boom DOWN arrow to lower the resident until his or her legs straddle the mast and his or her feet rest on the base of the resident lift.
- g) Pull the resident lift away from the bed and then push it from behind with both hands firmly on the steering handle.

⚠ WARNING: When lifting a resident, DO NOT lock the rear casters. Doing so could cause the lift to tip and could injure the resident or assistants.

After elevating the resident a few inches above stationary object, ensure the sling and all attachments are secure and properly connected. If any attachments are not properly in place, lower the resident back onto the stationary object and correct this problem.

Use of other manufacturers' components or accessories may compromise the operation of this resident lift. DO NOT use other manufacturer's components.

Transferring the Resident

⚠ WARNING: Do not attempt to transfer the resident without prior approval from medical professional.

⚠ WARNING: After elevating the resident a few inches above stationary object, ensure the sling and all attachments are secure and properly connected. If any attachments are not properly in place, lower the resident back onto the stationary object and correct this problem. Otherwise, damage or injury could occur. Adjustments for safety and comfort should be made before moving the resident. The resident's arms should be inside the straps.

⚠ WARNING: Only slings and accessories specifically designed for use with Direct Supply resident lifts should be used. Use of other manufacturers' components or accessories may compromise the operation of this resident lift.

⚠ WARNING: When lifting a resident, DO NOT lock the rear casters. Doing so could cause the lift to tip and could injure the resident or assistants.

⚠ WARNING: When lifting a resident, the legs of the lift must be in the maximum open position for stability and safety. If it is necessary to close the legs of the lift to maneuver the lift under a bed, close the legs of the lift only as long as it takes to position the lift over the resident and lift the resident off the surface of the bed. Return the legs of the lift to the maximum open position when the legs of the lift are no longer under the bed.

⚠ WARNING: Be sure to check the sling attachments each time the sling is removed and replaced to ensure it is properly attached before the resident is removed from a bed or chair. Slings with commode openings are designed to be used with either a commode chair or standard commode.

⚠ CAUTION: We recommend the sling remain connected to the Cradle/Hanger bar hooks during the resident's use of either the commode chair or standard commode.

Transferring to a Commode Chair

- a) Lift the resident from the bed. Refer to Lifting the Resident section.
- b) Press the boom up arrow to lift the resident high enough to clear the arms of the commode chair. His or her weight will be supported by the resident lift.
- c) Guide the resident onto the commode chair. This may require two assistants.
- d) Press the boom down arrow to lower the resident onto the commode chair, leaving the sling attached to the Cradle/Hanger bar hooks.
- e) When complete, recheck the sling for correct attachments.
- f) Press the boom up arrow to raise the resident off the commode chair.
- g) When the resident is clear of the commode surface, use the steering handles to move the resident lift away from the commode chair.
- h) To return the resident to bed, reverse the steps in Lifting the Resident section.
- i) To return or place the resident in a wheelchair, refer to Transferring to a Wheelchair section.

Transferring to a Standard Commode

This lift is not intended to transport a resident. It is intended only to transfer the resident from one surface to another, such as from a bed to a commode. Injury or damage may occur if not used as intended. If the bathroom facilities are NOT near the bed or if the resident lift cannot be easily maneuvered towards the commode, the resident MUST be transferred to a wheelchair and transported to the bathroom facilities before using the resident lift again to position the resident on a standard commode. Refer to Transferring to a Wheelchair section.

Transferring the Resident *(cont.)*

- a) To ensure the resident lift can maneuver around the commode, use an empty resident lift to confirm maneuverability.
- b) Once confirmed the resident lift can maneuver around the commode, lift the resident from the bed. Refer to Lifting the Resident section.
- c) To elevate the resident high enough to clear the commode, press the boom up/down arrows. The resident's weight will be supported by the resident lift.
- d) Carefully guide the resident onto the commode. This may require two assistants.
- e) Press the boom down arrow to lower the resident onto the standard commode leaving the sling attached to the Cradle/Hanger bar hooks.
- f) When complete, recheck the sling for correct attachments.
- g) Press the boom up arrow to raise the resident off the commode.
- h) When resident is clear of the commode surface, use the steering handle to move the lift away from the commode.
- i) To return the resident to bed, reverse the steps in Lifting the Resident section.
- j) To return or place resident in a wheelchair, refer to the Transferring to a Wheelchair section.

Transferring to a Bathing Unit

- a) Lift the resident from the bed. Refer to Lifting the Resident section.
- b) To elevate the resident high enough to clear the portable bath tub, press the boom up/down arrows.
- c) Slide the portable bath tub under the resident.
- d) Press the boom down arrow to lower the resident into the portable bath tub.
- e) Detach the sling from the Cradle/Hanger bar hooks.
- f) Attach the portable bath tub straps to the resident lift.
- g) Press the boom up arrow to raise the sides of the portable bath tub.
- h) Bathe the resident.
- i) Reverse this procedure to return the resident to bed.

Transferring to a Wheelchair

- a) Lift the resident from the bed. Refer to Lifting the Resident section.
- b) Ensure the legs of the lift with resident in the sling are in the maximum open position by moving the spreader adjustment handle from right to left to open legs.
- c) Move the wheelchair into position.
- d) To prevent movement of the wheelchair, engage the rear wheel locks.

⚠ WARNING: DO NOT place the resident in the wheelchair if the locks are not engaged. Before lowering the resident into the wheelchair, the wheelchair wheel locks **MUST** be in a locked position. Otherwise, injury can occur.

- e) For proper positioning, guide the resident's hips as far back as possible into the seat by using the straps or handles on the side and the back of the sling.
- f) Position the resident over the seat with their back against the chair back.
- g) Begin to lower the resident either by opening the control valve or by pressing the boom down arrow.
- h) Two assistants are recommended for this step – one assistant stands behind the chair and the other operates the resident lift. The assistant behind the chair pulls back on the grab handle (on select models) or sides of the sling to seat the resident well into the chair back. This will help maintain a good center of balance. Take care to prevent the chair from tipping forward.
- i) Leave the sling in place unless a divided leg sling was used. Remove a divided leg sling.
- j) Reverse Lifting the Resident section to return to the seating surface of the wheelchair.

Maintenance

Safety Inspection Checklist

Prior to providing the resident lift to a new user, a full product inspection is required. Regular cleaning is essential to smooth operation and extending the life of the resident lift. This will also reveal loose or worn parts that must be replaced.

To keep your resident lift in service, follow the maintenance procedures in this manual.

Casters and brakes should be cleaned and lubricated, and the axle and swivel bolts should be checked for tightness. Remove all debris from the wheel and swivel bearings. Replace worn parts immediately. Do not use the lift if you suspect any component is damaged or worn.

Maintenance Safety Inspection Checklist

Regular cleaning will reveal loose or worn parts, enhance smooth operation and extend the life expectancy of the lift.

Follow the maintenance procedures described in this manual to help keep your resident lift in continuous service.

Item	Initially	Inspect/Adjust Monthly
The Caster Base		
Inspect for missing hardware	X	X
Base opens/closes with ease	X	X
Inspect casters and axle bolts for tightness	X	X
Inspect casters for smooth swivel and roll	X	X
Inspect and clear wheels of debris	X	X
Inspect pivot joints for wear	X	X
The Mast		
Mast MUST be securely assembled to boom	X	X
Inspect for bends or deflections	X	X
Inspect pivot joints for wear	X	X
The Boom		
Check all hardware and hanger bar supports	X	X
Inspect for bends or deflections	X	X
Inspect bolted joints of boom for wear	X	X
Inspect to ensure the boom is centered between the base legs	X	X
Check the mast pivot bolt under the rubber boot; ensure the bolt is tightly secured	X	X
Inspect pivot joints for wear	X	X

Maintenance *(cont.)*

Item	Initially	Inspect/Adjust Monthly
The Hanger Bar		
Check the bolt/hooks for wear or damage	X	X
Check sling hooks for wear or deflection	X	X
Inspect pivot joints for wear	X	X
Actuator Assembly		
Inspect hardware on mast, boom and base	X	X
Check for wear or deterioration	X	X
(IF DAMAGED, RETURN TO FACTORY)	X	X
Cycle to ensure smooth quiet operation	X	X
Cleaning		
Whenever necessary	X	X
Slings & Hardware		
CHECK ALL SLING ATTACHMENTS each time it is used to ensure proper connection and resident safety	X	X
Inspect sling material for wear	X	X
Inspect straps for wear	X	X

Lift Lubrication

Designed for minimum maintenance, the resident lift should be checked and lubricated every six months to ensure safety and reliability. Keep all components clean and in good working order. DO NOT USE and contact Direct Supply immediately if you suspect your lift is damaged in any way. The casters MUST swivel and roll smoothly. Light grease may be applied to the ball-bearing swivel of the casters once a year. Apply more frequently if the casters are exposed to extreme moist conditions. Lubricate all pivot points. Remove excess lubricant from lift surface.

Lubricate the following points:

1. Hanger Bar
2. Boom Mounting Bracket
3. Boom/Mast Mount
4. Mast Mounting Bracket

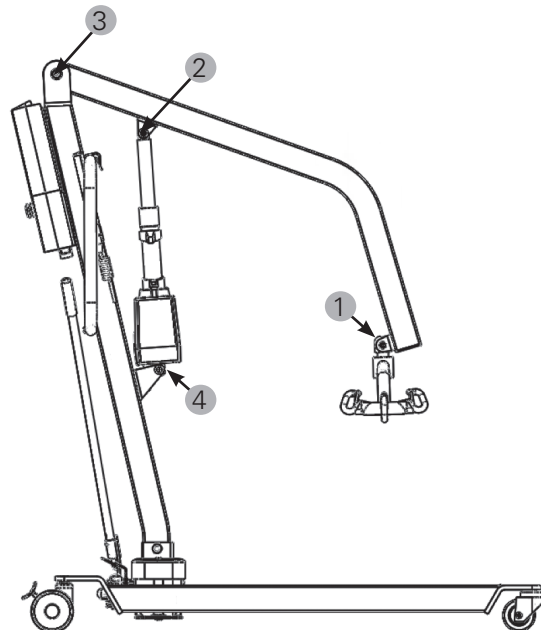

Detecting Wear & Damage

Inspect slings, Cradle/Hanger bar and any pivot for slings prior to each use for signs of deterioration, such as cracking or fraying. Replace worn parts immediately, and ensure the lift is not used until repairs are made.

Cleaning the Sling & Lift

The sling should be cleaned regularly in water (do not exceed 180°F (82°C)) and a biocidal (antibiological) solution. DO NOT use bleach when laundering the slings. Please refer to the sling manual and/or product label for correct washing instructions. Clean the resident lift with a damp, soft cloth and a small amount of mild detergent. Clean the lift with nonabrasive cleaners.

Boom Actuator Replacement

⚠ CAUTION: DO NOT overtighten the nut and bolt. Damage could occur.

- Remove the nut, washer and shoulder bolt that secure the electric actuator to the mast mounting bracket.
- Rest the boom on your shoulder and remove the nut, bolt, plastic bushing and pinch guard from the boom mounting bracket.
- Remove the boom actuator assembly.
- Reverse steps for installation.

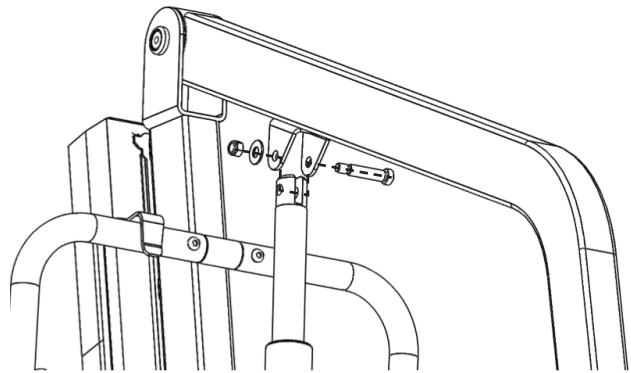

Mast Pivot Bolt

- Check that the bolt is through the bracket and the locknut is tight and secure.
- If needed, do one or more of the following:
Tighten locknut and back off the locknut $\frac{1}{8}$ of a turn.
Replace the locknut.

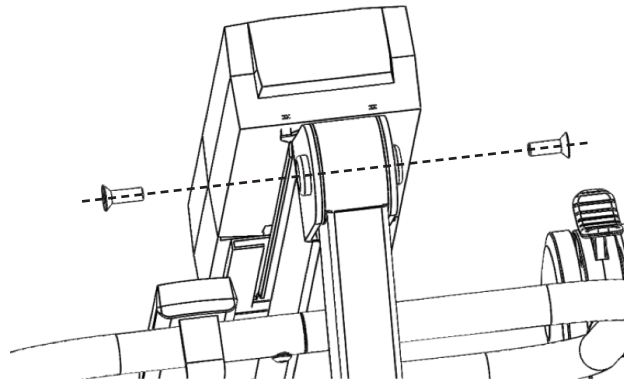

Maintenance *(cont.)*

Cradle/Hanger Bar Replacement

⚠ WARNING: After the first year of use, inspect the hooks of the Cradle/Hanger bar and the boom mounting brackets every three months. Replace worn out part as necessary.

- a) The Cradle/Hanger bar is attached to the boom with bolt, nut, washers and pinch guard.

⚠ CAUTION: Washers should be placed against both sides of the boom mounting bracket to eliminate damage. The Cradle/Hanger bar has three hooks on both ends to attach the sling supporting the resident during lifts.

- b) Remove existing hardware and replace the hanger bar.

⚠ CAUTION: DO NOT overtighten the nut and bolt. Damage could occur.

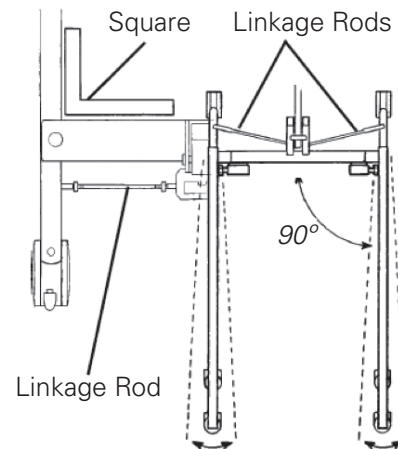
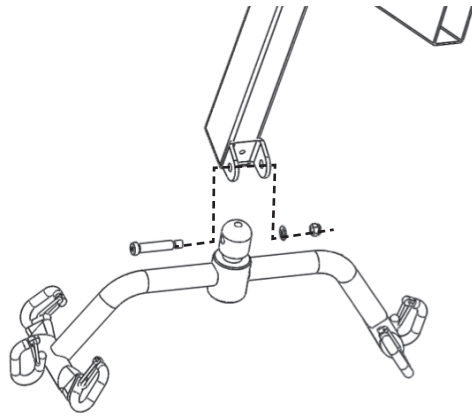

Base Adjustment

- a) When in the closed position, check that the legs are square.
- b) To determine 90-degree alignment, place a square on the inside of the legs and base.
- c) Adjust the linkage rods until 90-degree alignment is achieved.

Caster Replacement

⚠ WARNING: Ensure the floor is clear of debris before turning the resident lift on its side. Otherwise, damage or injury could occur.

Caster Replacement

- a) Place the lift on its side.
- b) Peel off the tape cover to expose the head of the Allen head bolt.
- c) Use a 6 mm Allen wrench on the head of the bolt and a 17 mm socket or wrench on the nut. If a socket is used, the wheel must be removed.
- d) Turn the wrench counterclockwise to remove the nut, and the wheel will come off. Reverse this procedure to install the replacement wheel.

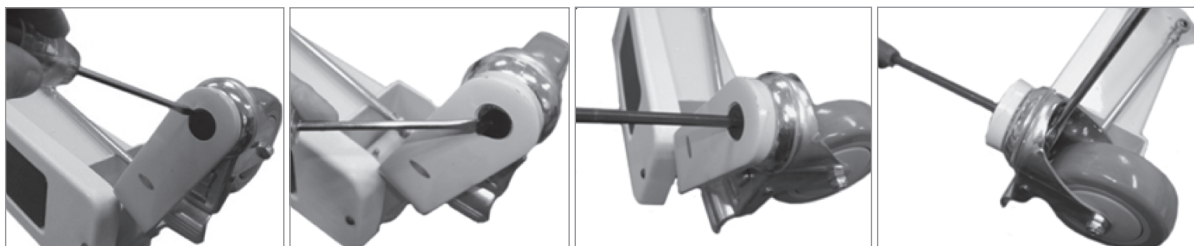

Troubleshooting

Symptoms	Troubleshooting	Possible Solution
Resident lift feels loose	Mast/base joint loose Tie – rods are loose	Refer to Lift Assembly on page 5. Refer to Base Adjustment on page 20.
Casters/brakes are noisy or stiff	Fluff or debris in bearings	Refer to Caster Replacement on page 20.
Noisy or dry sound from pivots	Needs lubrication	Refer to Lift Lubrication on page 18.
Actuator fails to lift or legs fail to open when button is pressed	Hand control or actuator connector loose	Charge batteries. Refer to Charging the Battery on page 13.
	Battery low	Rotate red emergency stop button CLOCKWISE until it pops out.
	Red emergency stop button pressed IN	Reconnect the battery to the control box. Refer to Charging the Battery on page 13.
	Battery not connected properly to control box	Replace the battery pack. Refer to Charging the Battery on page 13.
	Connecting terminals are damaged	Refer to Boom Actuator Replacement on page 19. Contact your dealer.
	Boom or leg actuator is in need of service or load is too high	
Unusual noise from actuator	Actuator is worn or damaged or spindle is bent	Refer to Boom Actuator Replacement on page 19. Contact your dealer.
Lift arms will not lower in uppermost position	Lift arms require a minimum weight load to lower from the uppermost position	Pull down slightly on the lift arms.
Lift arms will not lower during a power retraction	Shoulder bolt at the junction of the boom and mast may not be properly installed	Refer to Mast Pivot Bolt on page 19.

Contact Direct Supply if the above steps do not completely resolve your concern. Do not use the resident lift until you have confirmed it is functioning correctly.

Technical Data

Resident Lift

Electric Low-Profile Resident Lift, 450 lb. weight capacity

Height at Sling Hookup – MAX:	68.5"
Height at Sling Hookup – MIN:	21"
Base Width OPEN:	40"
Base Width CLOSED:	24"
Base Height (Clearance):	4.5"
Base Length:	45.5"
Caster Size (FRONT/REAR):	3" front/4" rear
Weight Capacity:	450 lbs.
Weight IN Carton:	136 lbs.
Weight OUT of Carton:	109 lbs.
Battery:	24V DC (RCHBL)
Charger Input:	100 - 240V AC
Charger Output/Charging Time:	29.5V DC Max 6 hours
Audible Low-Battery Alarm:	Yes
Motor Safety Device:	Anti-Entrapment
Approximate Lifts per Charge:	Varies depending on load and stroke: 100 - 200 cycles per charge

Limited Warranty

We offer to you, as the original purchaser, a warranty for the Direct Supply Atlas Floor Lift. Our warranty applies for the limited warranty period stated below. If any device or device part listed below is defective in material or workmanship during the applicable limited warranty period, we will repair or replace it at our cost. Please note that the decision to repair or replace a device or device part will be at our discretion. Our warranty applies only if the device is properly maintained by the original purchaser for normal, indoor use and does not cover normal wear and tear, modification of the device, or damage caused by abuse, improper use, failure to maintain, use which exceeds the published device limitations, or the combination of any device with another product. In addition, our warranty does not cover fading, colorfastness, stains, spills or exposure to chemicals, odors, heat or light. In certain cases, we may provide you repair or adjustment instructions and/or replacement parts and ask you to perform a repair or adjustment or replace a defective part.

Our warranty gives you specific legal rights, and you may also have other rights, which vary from state to state. Please note that our limited warranty period begins when we ship the device to you. The limited warranty period and our obligations under the warranty end once you transfer the device to someone else or at the end of the applicable limited warranty period identified below, whichever is earlier.

	Warranty Period (Parts Only)	Anticipated Usable Device Life
Frame	5 years	5 years
Electrical Parts/Components	1 year	1 year

Anticipated Usable Device Life is based on normal use with proper maintenance, cleaning and storage. You should still inspect, monitor and care for the device as described in this guide, as the device may need to be replaced sooner than anticipated in particular situations.

DIRECT SUPPLY MANUFACTURING, INC. MAKES NO IMPLIED WARRANTIES OF MERCHANTABILITY OR FITNESS FOR A PARTICULAR PURPOSE; THESE AND ALL OTHER IMPLIED WARRANTIES ARE SPECIFICALLY DISCLAIMED. TO THE FULLEST EXTENT ALLOWED BY LAW, DIRECT SUPPLY MANUFACTURING, INC. WILL NOT BE LIABLE FOR ANY INCIDENTAL, SPECIAL, CONSEQUENTIAL OR PUNITIVE DAMAGES, OR LOST PROFITS THAT MAY RESULT FROM THE DEVICE OR YOUR USE OR INABILITY TO USE THE DEVICE EVEN IF ADVISED OF THE POSSIBILITY OF SUCH DAMAGES. OUR TOTAL LIABILITY TO YOU, IF ANY, IS LIMITED TO THE PRICE OF THE PRODUCT OR SERVICE GIVING RISE TO YOUR CLAIM.

Some states do not allow an exclusion or limitation of incidental or consequential damages, or how long an implied warranty lasts, so the above limitations or exclusions may not apply to you. If implied warranties are not excluded, and to the extent allowed by law, we limit any and all implied warranties to the applicable warranty period identified above. Except for rights under any applicable state law, the remedies provided under this warranty are your sole and exclusive remedy for any breach of our warranty and state the entire limit of our responsibilities.

Customer Service

Our promise to you is that you will have a convenient and easy ordering experience, receive a quality Direct Supply Atlas Floor Lift, and enjoy outstanding customer service. If you have any questions about the resident lift you have purchased or would like to request warranty service, please contact: **Direct Supply Equipment & Furnishings** at 1-800-634-7328, 6767 N. Industrial Road, Milwaukee, WI 53223, SalesSupport@DirectSupply.com.



DirectSupply.com

Aptura / Equipment & Furnishings / Capital Projects / DSSI / TELS

Distributed by Direct Supply Manufacturing, Inc. 6635 N Industrial Road, Milwaukee, WI 53223.

© 2016 Direct Supply Manufacturing, Inc. All Rights Reserved. Direct Supply®, and all associated logos are the registered trademarks of Direct Supply, Inc., used under license.