



Direct Supply® Direct Choice™ Stools

Product Warranty

Customer Service

Our promise to you is that you will have a convenient and easy ordering experience, receive a quality product and enjoy outrageous customer service. If you have any questions about the products you have purchased or would like to request warranty service, please contact us at: Direct Supply®, Inc., 1-800-634-7328, 6767 North Industrial Road, Milwaukee, WI 53223, deardirect@directsupply.net.

Limited Warranty

We offer to you, as the original purchaser, a warranty for the frame and base as well as the upholstered components of your Direct Choice Stool. Our warranty applies for the warranty period stated below. If any product or product part listed below is defective in material or workmanship during the applicable warranty period, we will repair or replace it at our cost. Please note that the decision to repair or replace a product or product part will be at our discretion. Our warranty applies only if the product is properly maintained by the original purchaser for normal, indoor use and does not cover normal wear and tear, modification of the product, or damage caused by abuse, improper use, failure to maintain, use which exceeds the published product limitations, or the combination of any product with another product. In addition, our warranty does not cover fading, characteristics or natural variations in wood grain or fabric, texture, colorfastness, stains, spills, or exposure to chemicals, odors, heat or light. In certain cases, we may provide you repair or adjustment instructions and/or replacement parts, and ask you to perform a repair or adjustment or replace a defective part. Our warranty gives you specific legal rights, and you may also have other rights, which vary, from state to state.

Product/Part	Warranty Period & Coverage (Parts)	Anticipated Usable Product Life
Stool Frame/Base	2 years	2 years
Upholstered Components	2 years	2 years

Please note that our limited warranty period begins when we ship the product to you. The warranty period and our obligations under the warranty end once you transfer the product to someone else or at the end of the applicable warranty period identified above, whichever is earlier.

While we want you to be completely satisfied with your purchase, there are reasonable limitations and exclusions that apply. DIRECT SUPPLY MANUFACTURING, INC. MAKES NO IMPLIED WARRANTIES OF MERCHANTABILITY OR FITNESS FOR A PARTICULAR PURPOSE; THESE AND ALL OTHER IMPLIED WARRANTIES ARE SPECIFICALLY DISCLAIMED. TO THE FULLEST EXTENT ALLOWED BY LAW, DIRECT SUPPLY MANUFACTURING, INC. WILL NOT BE LIABLE FOR ANY INCIDENTAL, SPECIAL, CONSEQUENTIAL OR PUNITIVE DAMAGES, OR LOST PROFITS THAT MAY RESULT FROM THE DEVICE OR YOUR USE OF OR INABILITY TO USE THE DEVICE EVEN IF ADVISED OF THE POSSIBILITY OF SUCH DAMAGES. OUR TOTAL LIABILITY TO YOU, IF ANY, IS LIMITED TO THE PRICE OF THE DEVICE OR SERVICE GIVING RISE TO YOUR CLAIM. Some states do not allow an exclusion or limitation of incidental or consequential damages or how long an implied warranty lasts, so the above limitations or exclusions may not apply to you. If implied warranties are not excluded, and to the extent allowed by law, we limit any and all implied warranties to the applicable warranty period identified above. Except for rights under any applicable state law, the remedies provided under this warranty are your sole and exclusive remedy for any breach of our warranty and state the entire limit of our responsibilities.

Stool Assembly Instructions

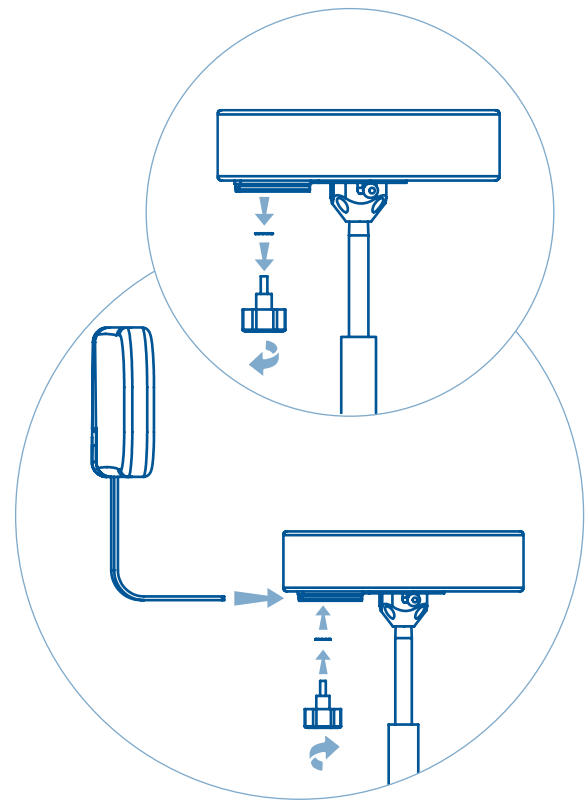
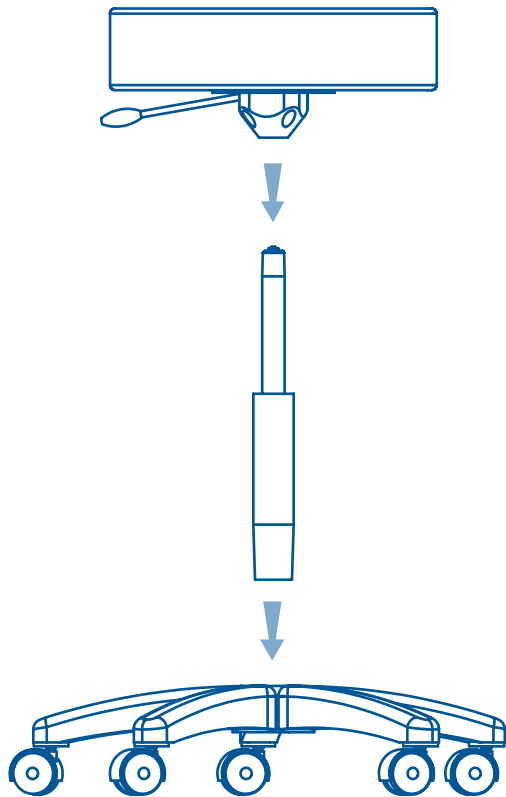

Optional Backrest

Height Adjustment

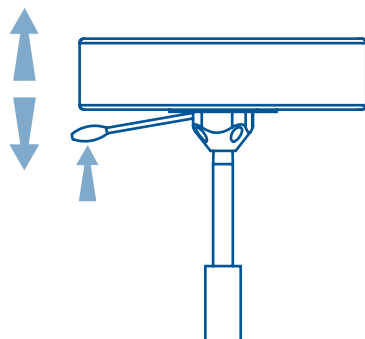

Pneumatic Model

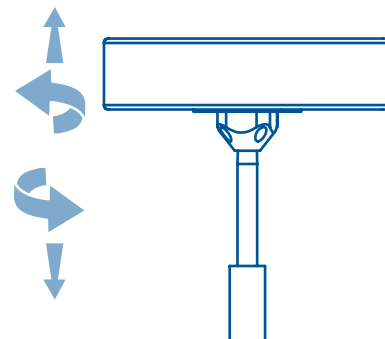

Spin Lift Model

Direct Supply® Direct Choice™ products are available to purchase exclusively through Direct Supply Equipment & Furnishings®, a division of Direct Supply, Inc. Distributed by Direct Supply Manufacturing, Inc. 6699 N Industrial Road, Milwaukee WI 53223.

©2012 Direct Supply Manufacturing, Inc. All Rights Reserved. Direct Supply®, Direct Choice™, and all associated logos are the registered trademarks of Direct Supply Inc., used under license.